



Purcell Avenue, Whitestone, Nuneaton, CV11 4SW

£112,500





Purcell Avenue, Whitestone, Nuneaton, CV11 4SW

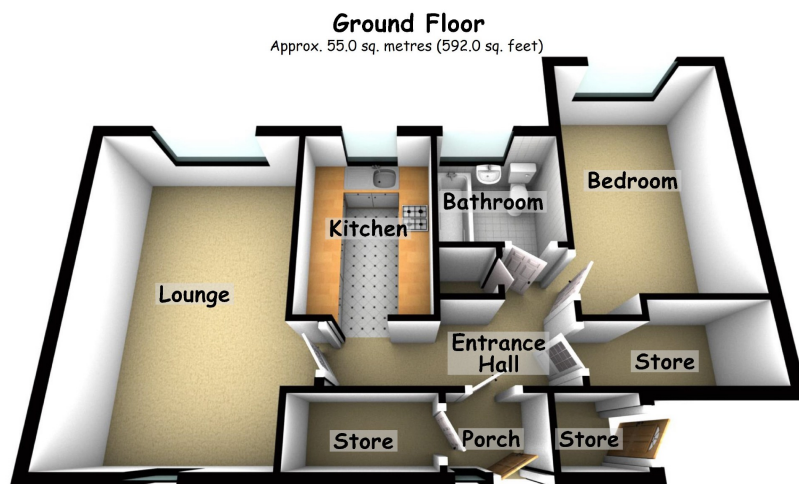

Total area: approx. 55.0 sq. metres (592.0 sq. feet)

An attached bungalow with the benefit of UPVC double glazing and electric storage heating (as and where specified) and briefly comprising entrance porch, hall with deep storage cupboard, lounge/dining room, kitchen, bedroom, bathroom with white suite and shower, communal gardens and parking.

As the sellers agent we are not surveyors or conveyancing experts and as such we cannot and do not comment on the condition of the property or issues relating to title or other legal issues that may affect this property, unless we have been made aware of such matters. Interested parties should employ their own professionals to make such enquiries before making any transactional decisions.

ALL ON THE GROUND FLOOR

ENTRANCE PORCH

UPVC double glazed entrance door and side light and storage cupboard.

ENTRANCE HALL

Electric storage heater, built-in airing cupboard housing hot water cylinder with immersion heater and deep storage cupboard.

LOUNGE/DINING ROOM

16'7" x 10'4" plus door recess (5.05m x 3.15m plus door recess)

Two UPVC double glazed windows, TV aerial point and electric storage heater.

KITCHEN

9'5" x 6'7" (2.87m x 2.01m)

Matching range of base and wall units, roll edge work surfaces, inset single bowl stainless steel sink unit, space and plumbing for washing machine, space and point for electric cooker and UPVC double glazed window.

BEDROOM

13'5" plus recess x 8'7" (4.09m plus recess x 2.62m)

UPVC double glazed window and electric storage heater.

BATHROOM

Matching white suite comprising panelled bath with shower, low level WC, pedestal wash hand basin, tiling to splash backs and UPVC double glazed window.

OUTSIDE

COMMUNAL GARDENS

The property is set within well tended communal gardens which are maintained in line with the service charge.

SERVICE CHARGE

We understand that a service charge is payable to Orbit Housing. We await confirmation.

Viewing

Strictly by arrangement through Loveitts Nuneaton office

39 Church Street, Nuneaton. CV11 4AD

Tel: 024 7634 7676

email: nuneaton@loveitts.co.uk

003

