

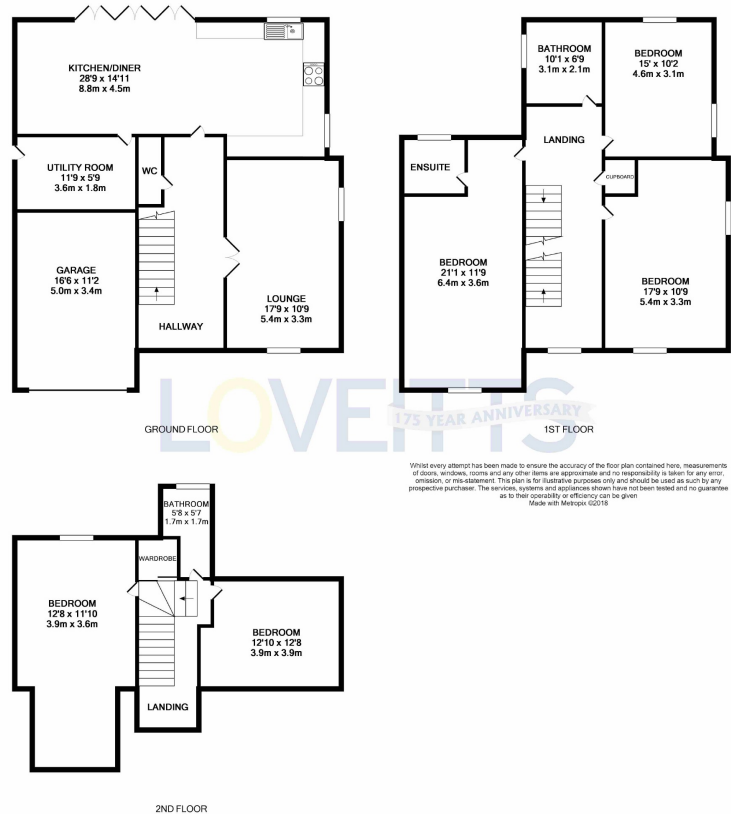

**| The Laurels, Coventry, CV7 8NJ**

**£650,000**





Coming soon- An exclusive development of only two, unique and executive detached homes. These executive style properties will be ready to move in to during the spring of 2019. Designed for modern, family living and having luxury at the forefront of the design, the high specification and attention to detail will not fail to impress.

Positioned on a small private road off Sandpits Lane, Tamworth Road, these homes are outstandingly private and secluded. Within a stone's throw of Coundon Hall Park and some of Warwickshire's best countryside walks. Minutes from Coventry City Centre or a short commute to neighbouring Birmingham via the villages of Fillongley, Corley and Meriden.

Five bedrooms, a spacious lounge, a stunning and stylish kitchen with integral appliances, superior bathroom suites and an abundance of space.

The developer is happy to offer flexibility relating to fixtures, fittings and flooring throughout and all sales agreed are subject to a reservation fee.

As the sellers agent we are not surveyors or conveyancing experts and as such we cannot and do not comment on the condition of the property or issues relating to title or other legal issues that may affect this property, unless we have been made aware of such matters. Interested parties should employ their own professionals to make such enquiries before making any transactional decisions.

Entrance Hall

Lounge

Kitchen Diner

Ground Floor WC

Utility Room

Bedroom

Bedroom

Bedroom

Bathroom

Bedroom

En-Suite