



Hampton Court Road, KT8

£1,550 PCM

Set in a private development, this well presented one bedroom maisonette has been finished to high standard throughout and benefits from allocated parking and landscaped communal gardens leading to the River Thames.



Rotary Court is a fantastic location adjacent to the Royal Mews and opposite Hampton Court Green. Bushy Park, Hampton Court Palace, Hampton Court train station and the River Thames are all within a short walk.

- One Double Bedroom • Modern Throughout • Allocated Parking •
- Own Entrance • Landscaped Gardens • Riverside Development •



SNELLERS

ESTATE AGENTS

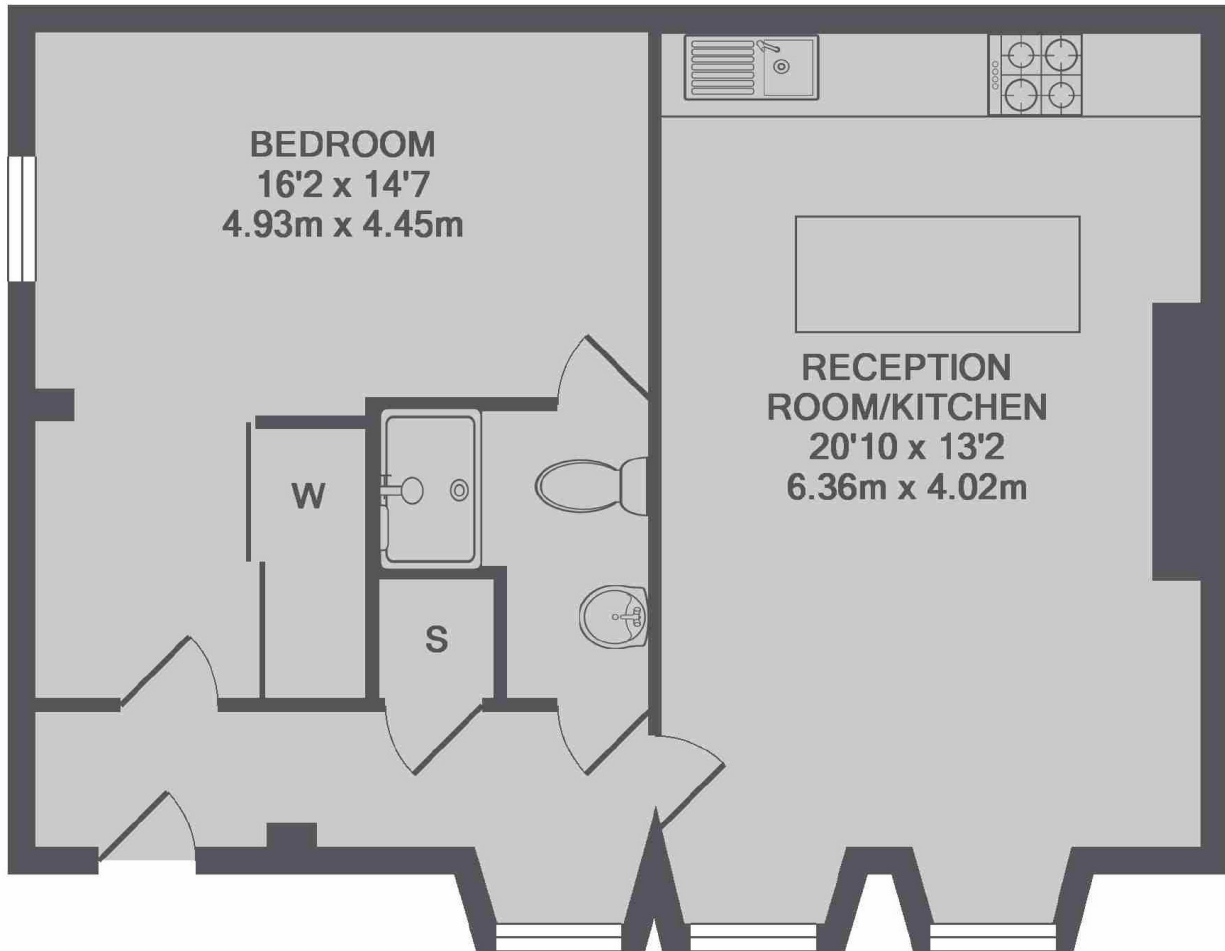

TOTAL APPROX. FLOOR AREA 580 SQ.FT. (53.9 SQ.M.)

Snellers Hampton Hill Sales
197-201 High Street
Hampton Hill
TW12 1NL
020 8783 0083
hamptonsales@snellers.co.uk

Energy Rating: D We aim to make our particulars both accurate and reliable. However they are not guaranteed; nor do they form part of an offer or contract. If you require clarification on any points then please contact us, especially if you're traveling some distance to view. Please note that appliances and heating systems have not been tested and therefore no warranties can be given as to their good working order