

# SNELLERS

ESTATE AGENTS

---



**Kingston Road, TW11**

**£2,300 PCM**

A ground floor Edwardian maisonette with a large private south westerly facing garden. Repainted throughout the property has a spacious front reception room, kitchen with breakfast bar, two bedrooms and bathroom.



Positioned less than a mile to Teddington Town Centre and both Teddington and Hampton Wick Train Stations. Bushy Park and Broom Park are also within easy reach.

- Edwardian Maisonette • Large Private Garden • Eat In Kitchen •
- High Ceilings • Side Access • Two Bedrooms •





## Ground Floor

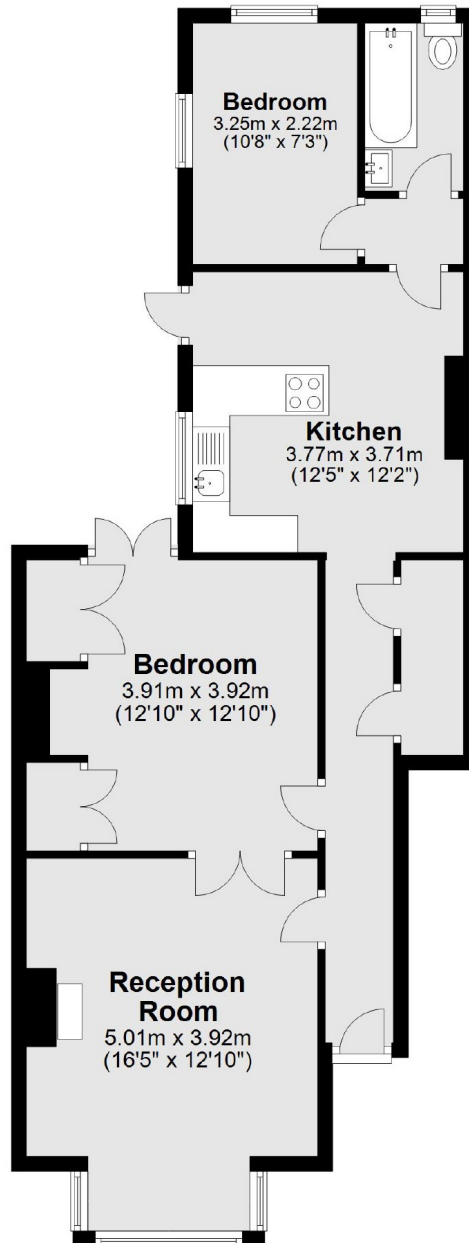

Total area: approx. 69.1 sq. metres (743.3 sq. feet)

Snellers Teddington Lettings  
74 Broad Street  
Teddington  
TW11 8QX  
020 8614 6140  
[teddingtonlettings@snellers.co.uk](mailto:teddingtonlettings@snellers.co.uk)

Energy Rating: D We aim to make our particulars both accurate and reliable. However they are not guaranteed; nor do they form part of an offer or contract. If you require clarification on any points then please contact us, especially if you're traveling some distance to view. Please note that appliances and heating systems have not been tested and therefore no warranties can be given as to their good working order