

# SNELLERS

ESTATE AGENTS



## Elmtree Road, TW11

£425,000

Arguably one of the most stylish properties on the market is this wonderful one double bedroom first floor modern apartment that would be a perfect first time purchase or investment. Further benefits include a gated allocated parking space, a long lease and a secure entry phone system.

Elmtree Road is located between Somerset Road and Shacklegate Lane, approximately half a mile from Teddington mainline station which offers a direct link to London Waterloo. Teddington high street boasts a vast array of boutique shops, café's pubs and restaurants.

- One Double Bedroom • Excellent Condition • Allocated Parking Space •
- First Floor • Entry Phone System • Long Lease •

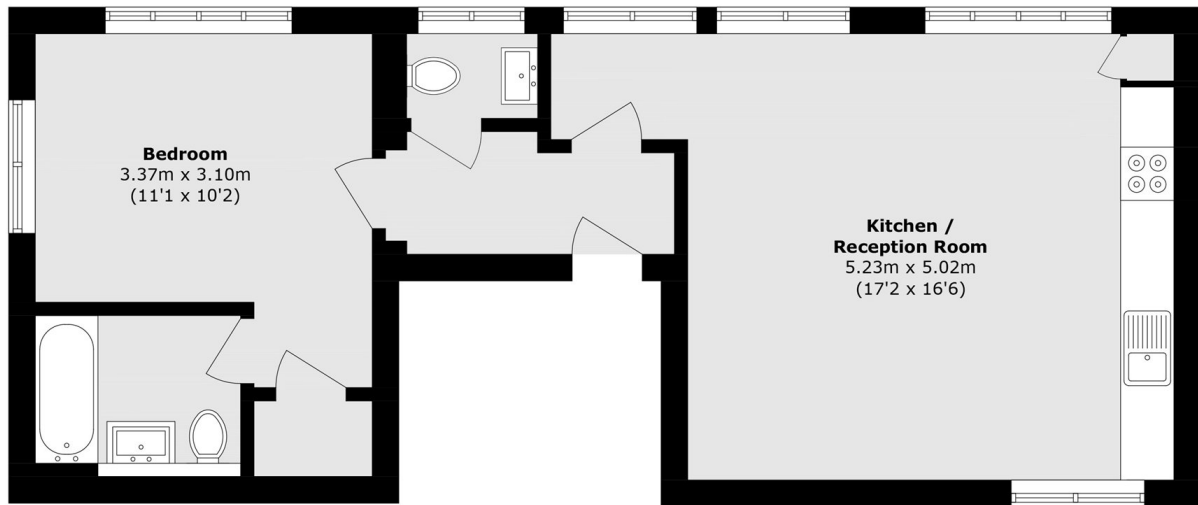

Total area (approx.): 55.1 sq. m (593.1 sq. ft)

Snellers Teddington Sales  
74 Broad Street  
Teddington  
TW11 8QX  
020 8408 8040  
[teddingtonsales@snellers.co.uk](mailto:teddingtonsales@snellers.co.uk)

Energy Rating: C We aim to make our particulars both accurate and reliable. However they are not guaranteed; nor do they form part of an offer or contract. If you require clarification on any points then please contact us, especially if you're traveling some distance to view. Please note that appliances and heating systems have not been tested and therefore no warranties can be given as to their good working order