

SNELLERS

ESTATE AGENTS



Edgar Road, TW4

£1,450 PCM

This one bedroom apartment is set on the seventh floor of a well maintained building in Whitton. It has a large reception room, separate kitchen, double bedroom with good storage and a modern bathroom.

The development is located moments away from a small parade of shops and amenities and one mile from Hounslow Station and just over a mile from Whitton Station, for trains into Waterloo and out of London. The A316 that takes you into central London by car is close by, as well as the M3 that connects you to the south coast, the M25 and A3.

- Available Now • Newly Refurbished • Lift Access •
- One Double Bedroom • Parking • London Skyline Views •

SNELLERS

ESTATE AGENTS

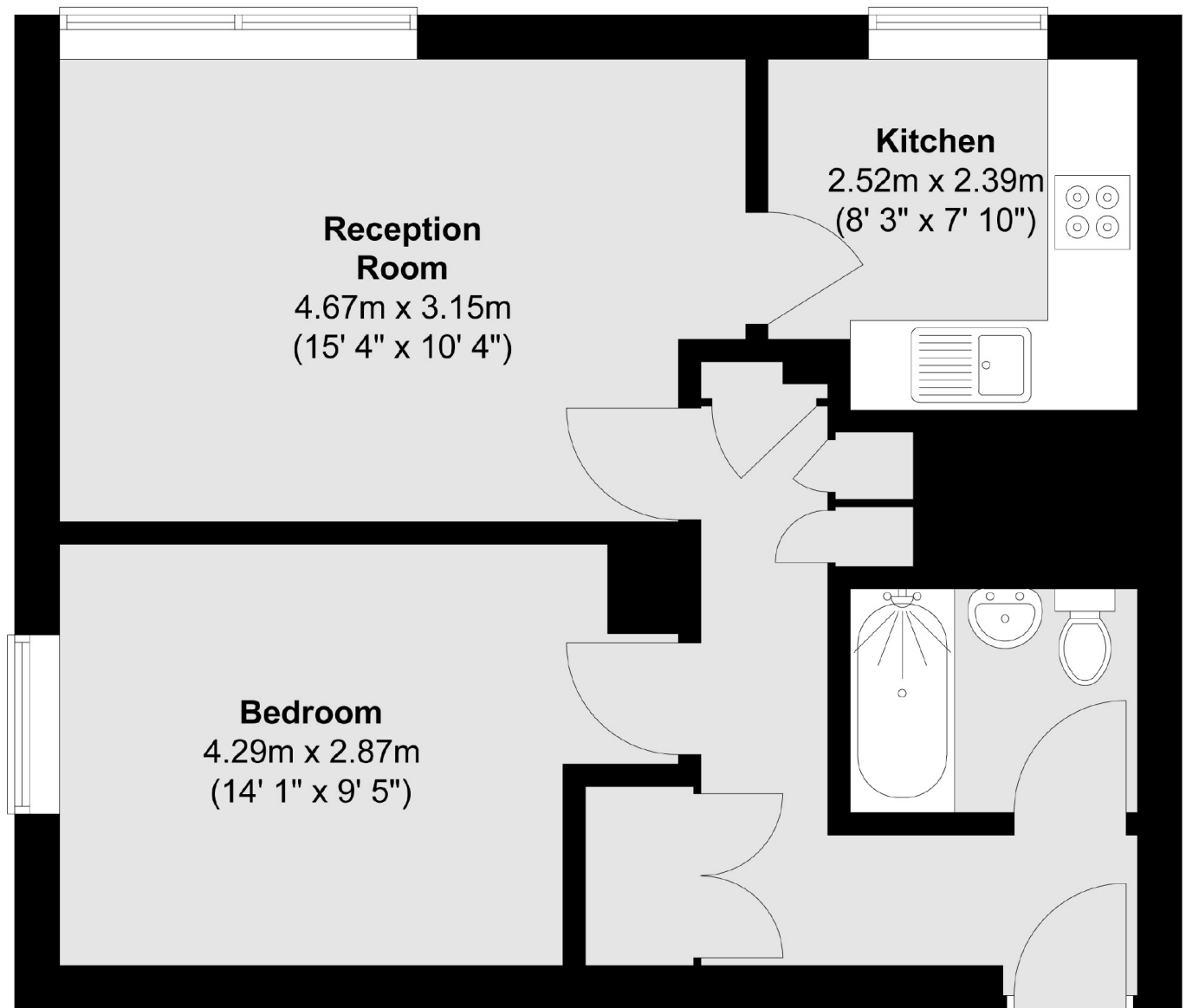

Total area (approx.) : 45.5 sq. m (490 sq. ft)

Snellers Twickenham Lettings
64-66 Heath Road
Twickenham
TW1 4BX
020 8892 5678
twickenhamlettings@snellers.co.uk

Energy Rating: C We aim to make our particulars both accurate and reliable. However they are not guaranteed; nor do they form part of an offer or contract. If you require clarification on any points then please contact us, especially if you're traveling some distance to view. Please note that appliances and heating systems have not been tested and therefore no warranties can be given as to their good working order