



Lorne Close, NW8

£650,000

A two bedroom top floor apartment located in a modern gated development off Park Road. The apartment is offered in good condition throughout and benefits from a private balcony.

Lorne Close is almost opposite Regents Park and is conveniently located for the transport and amenities of both St John's Wood and Baker Street.

Features

- Private Balcony
- Great Transport Links
- Separate Kitchen
- Dual Aspect
- Off-Street Parking
- Chain Free

Lorne Close, London, NW8

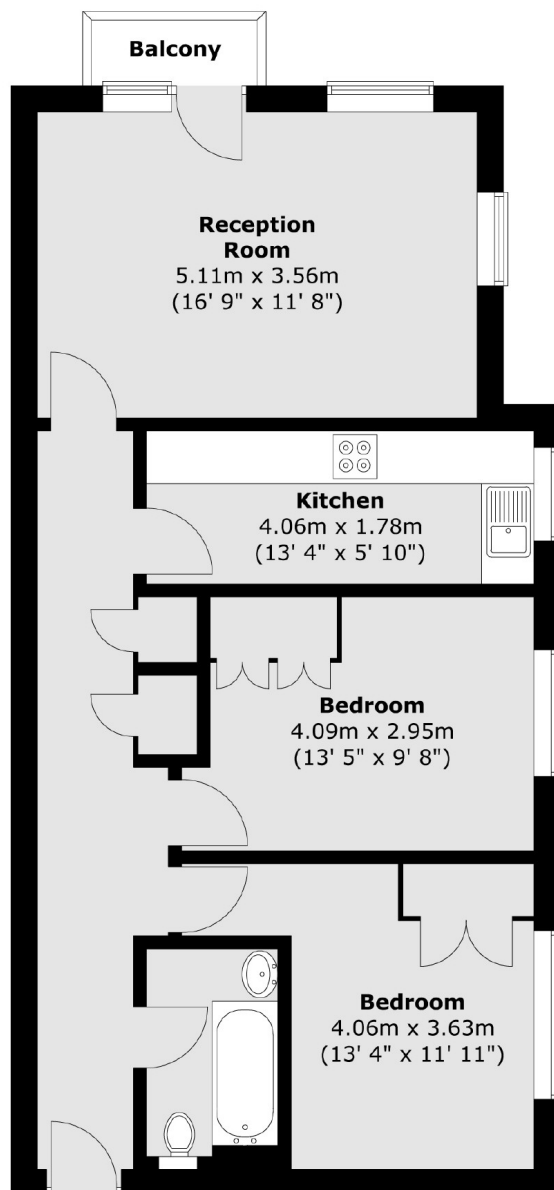

Total area (approx.) : 68.8 sq. m (740 sq. ft)
Total balcony area (approx.) : 1 sq. m (11 sq. ft)

Dexters

St. John's Wood
4-6 St Ann's Terrace
London
NW8 6PJ
Sales
020 7483 6300

Energy Rating: C. We aim to make our particulars both accurate and reliable. However they are not guaranteed; nor do they form part of an offer or contract. If you require clarification on any points then please contact us, especially if you're traveling some distance to view. Please note that appliances and heating systems have not been tested and therefore no warranties can be given as to their good working order.

 **RICS** | Regulated
Estate Agent
and Letting Agent

[dexters.co.uk](https://www.dexters.co.uk)