



Primrose Hill Road, NW3

£507 Per week

A bright one double bedroom apartment on the eighth floor of a portered block in Primrose Hill. Spacious reception room with balcony and views of London, separate kitchen, double bedroom with good built in storage and bathroom with shower over bath. Parking included.

Kings College Court is located a short distance to the open spaces of Primrose Hill and a good range of local shops, restaurants and cafés on England's Lane.

Features

- One Double Bedroom
- Separate Kitchen
- Balcony With Views Of London
- Porter Service
- 8th Floor Via Lift
- Parking

**Primrose Hill Road,
London, NW3**

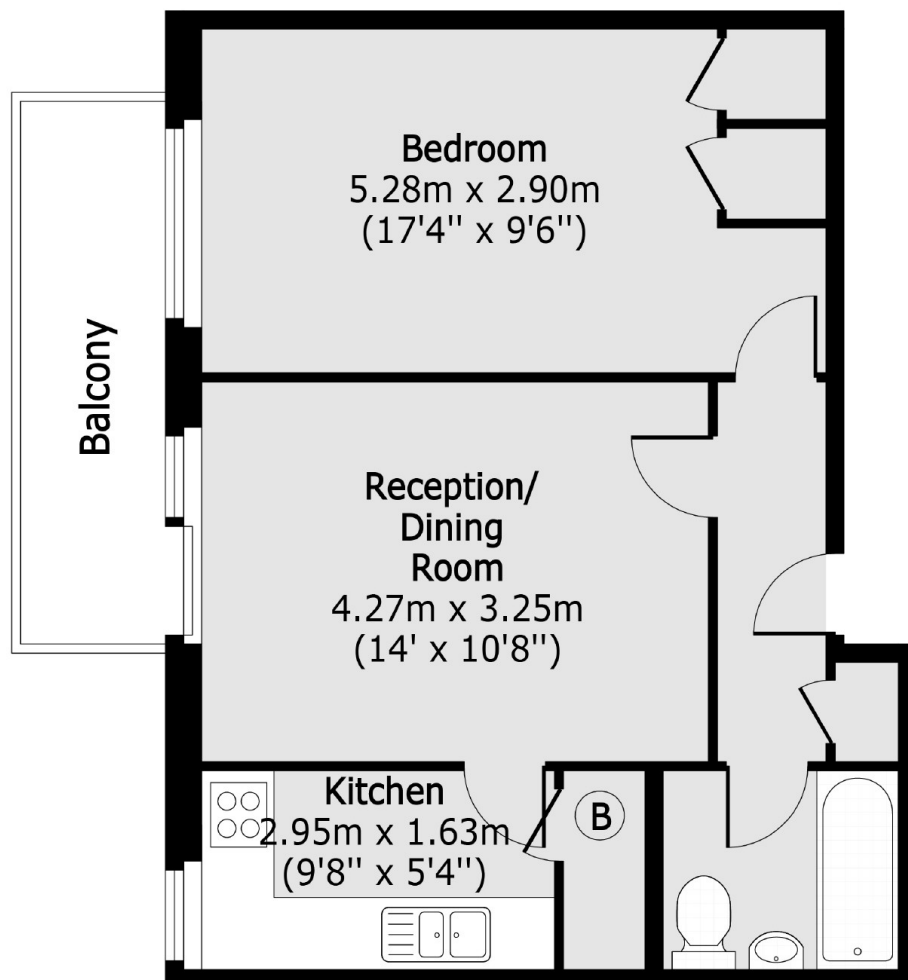

Total area (approx): 43.29 sq m (466 sq. ft)

Balcony total area (approx): 5.57 sq m (60 sq. ft)