

Abercorn Place, NW8

£400,000

A modern one double bedroom apartment in one of the most desirable portered blocks in St Johns Wood. Bright reception room, separate kitchen, double bedroom and bathroom. One of the few apartments in the building that have a spectacular view of London.

Abercorn Place is located off of Abbey Road and is ideally located in between St Johns Wood and Maida Vale underground stations giving tenants great transport links into the city.

Features

- One Double Bedroom
- Portered Block
- Amazing Views
- Sixth Floor Apartment
- Lift
- Communal Garden

Abercorn Place, London, NW8

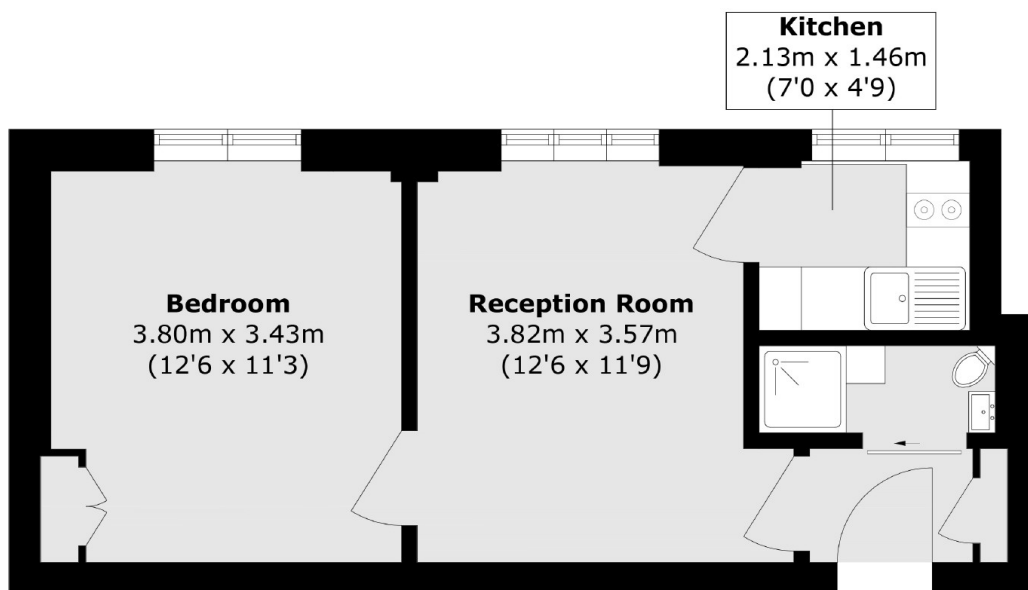

Total area (approx.): 34.4 sq. m (370.2 sq. ft)