



Park Walk, SW10

£995,000

A wonderfully designed two bedroom apartment with lovely views, plenty of natural light and excellent proportions. This property is positioned on the corner of a handsome red-brick mansion block with the benefit of residential caretakers.

Elm Park Mansions is a gated development located on Park Walk which is a pretty tree-lined street situated between the King's Road and Fulham Road.

Features

- Share of Freehold
- Gated Development
- Resident Caretakers
- Two Double Bedrooms
- Fantastic Condition
- Quiet Location

Park Walk, London, SW10

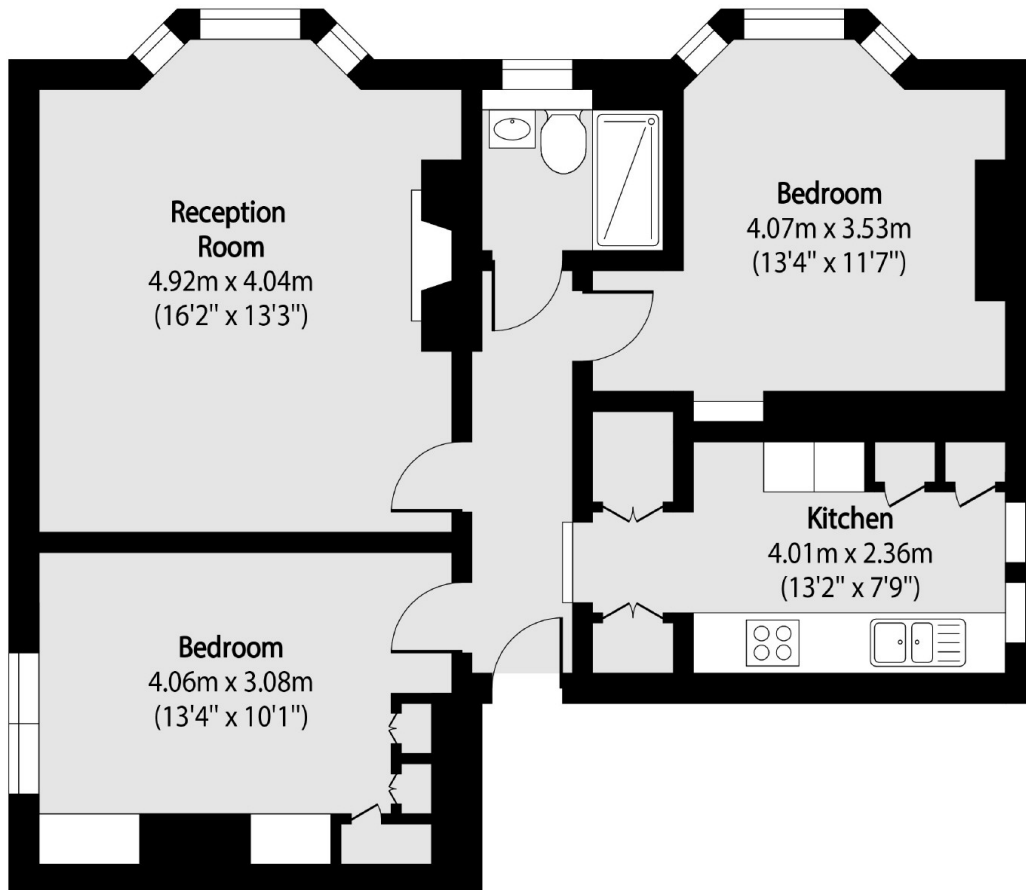

Third Floor

Total area (approx): 64.83 sq m (698 sq. ft)