



Whiteheads Grove, SW3

£1,350,000

A modern three bedroom apartment measuring close to 1000sqft, filled with natural light. This property is located on the seventh floor (with lift) and benefits from a share of the freehold as well as portage.

Cranmer Court is a popular, portered building moments from Chelsea Green, Sloane Square and Pavilion Road. Local transport links, restaurants, boutique shops and cafés are located close by.

Features

- Share of Freehold
- Popular Location
- Porter
- Lift
- Three Bedrooms
- Great Natural Light

Whiteheads Grove, London, SW3

Whiteheads Grove, SW3 3HG

Approx Gross Internal Area = 88 sq m / 947 sq ft

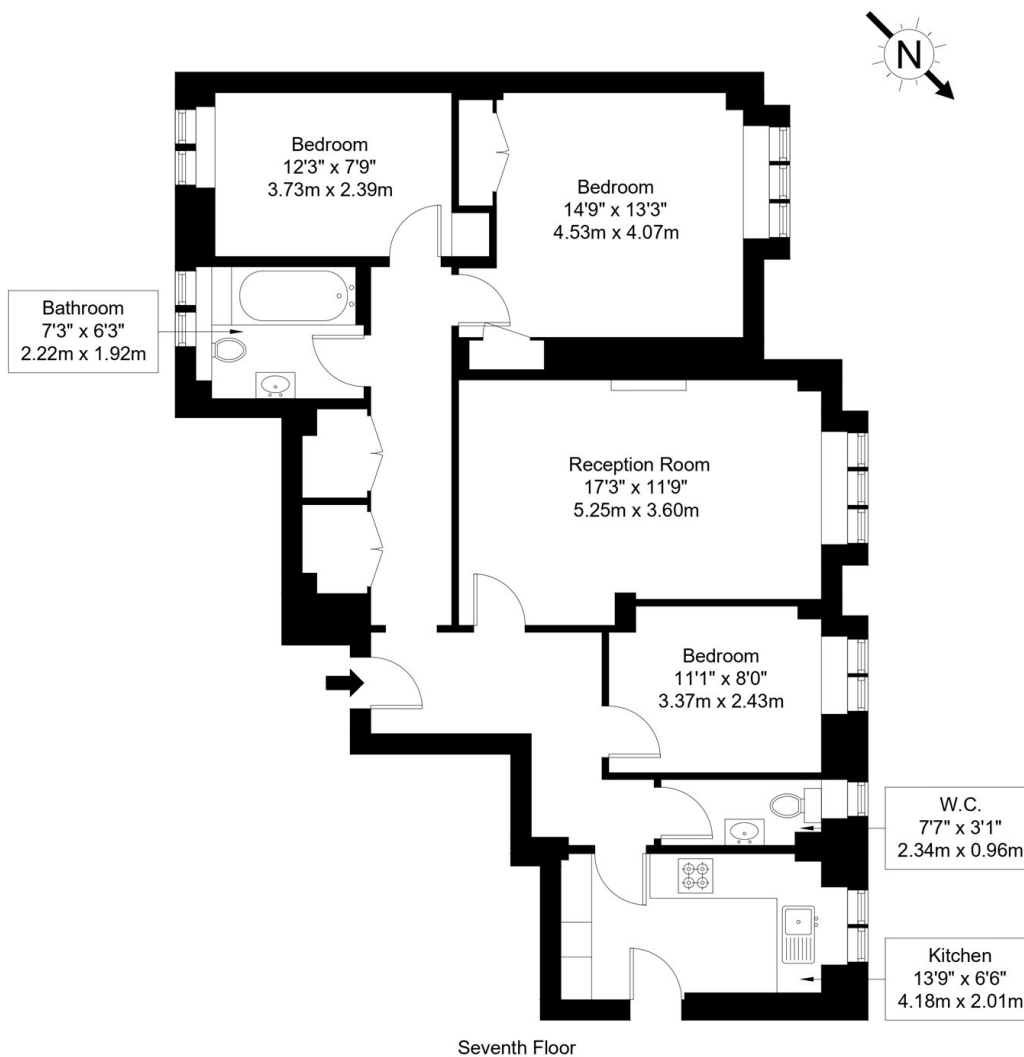

Ref :

Copyright **BLEU
PLAN**

The Floor plan is not to scale and measurements and areas shown are approximate and therefore should be used for illustrative purposes only. The plan has been prepared in accordance with the RICS code of Measuring Practice and whilst we have confidence in the information produced it must not be relied on. Maximum lengths and widths are represented on the floor plan. If there is any aspect of particular importance, you should carry out or commission your own inspection of the property.

Copyright @ BLEUPLAN

Dexters

Chelsea and Belgravia
45 Sloane Avenue
London
SW3 3DH
Sales
020 7590 9510

Energy Rating: C. We aim to make our particulars both accurate and reliable. However they are not guaranteed; nor do they form part of an offer or contract. If you require clarification on any points then please contact us, especially if you're traveling some distance to view. Please note that appliances and heating systems have not been tested and therefore no warranties can be given as to their good working order.

 **RICS** | Regulated
Estate Agent
and Letting Agent

dexters.co.uk