

Hammersmith Road, W6

£450 Per week

A very well presented one bedroom flat with heating and hot water included in the rent. The property is located within a popular development with a spacious living area, separate kitchen and large bedroom with built-in storage. There is plenty of light throughout. Further benefits include lift access & 24 hour security and reception.

The property is located in Latymer Court in Hammersmith, close to Hammersmith tube station and the amenities of Hammersmith Broadway.

Features

- One Bedroom
- Heating & Hot Water Included
- 24 Hour Concierge
- Bright & Spacious
- Central Location

Hammersmith Road, London, W6

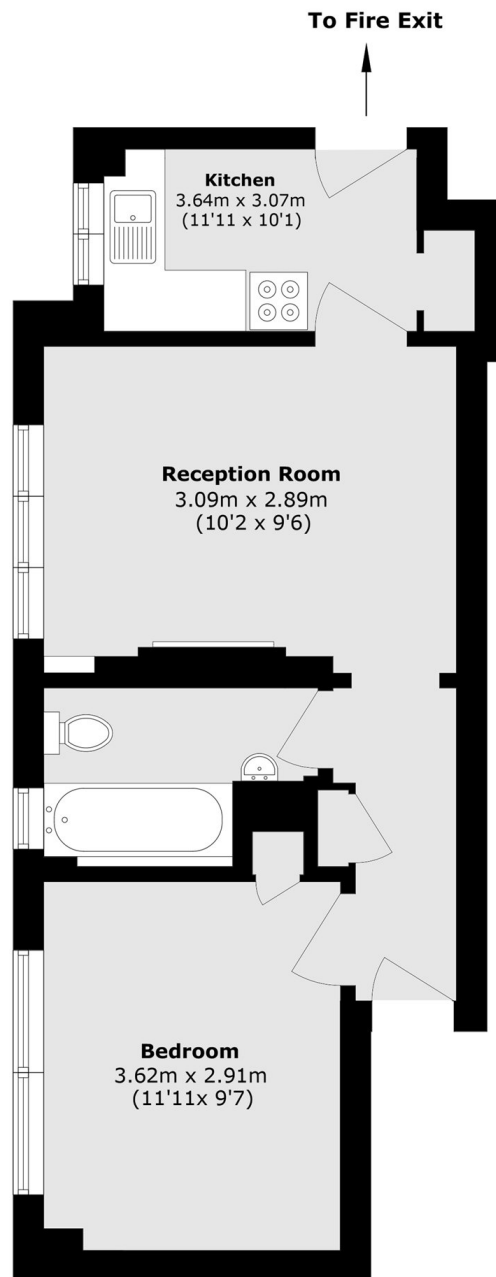

Total area (approx.): 39.5 sq. m (425.1 sq. ft)