

Shirland Road, W9

£450,000

A well-presented ground floor flat set in a Victorian period conversion. The property offers two good sized bedrooms, a bright and spacious reception room with large sash windows and high ceilings, and a separate kitchen. The property is being offered chain free.

Shirland Road is ideally located for both Maida Vale and Warwick Avenue underground stations (Bakerloo line), the open spaces of Paddington Recreational Ground and a number of independent shops.

Features

- Ground Floor Flat
- Two Bedrooms
- Separate Kitchen
- High Ceilings
- Chain Free
- Excellent Transport Links

Shirland Road, Maida Vale, W9

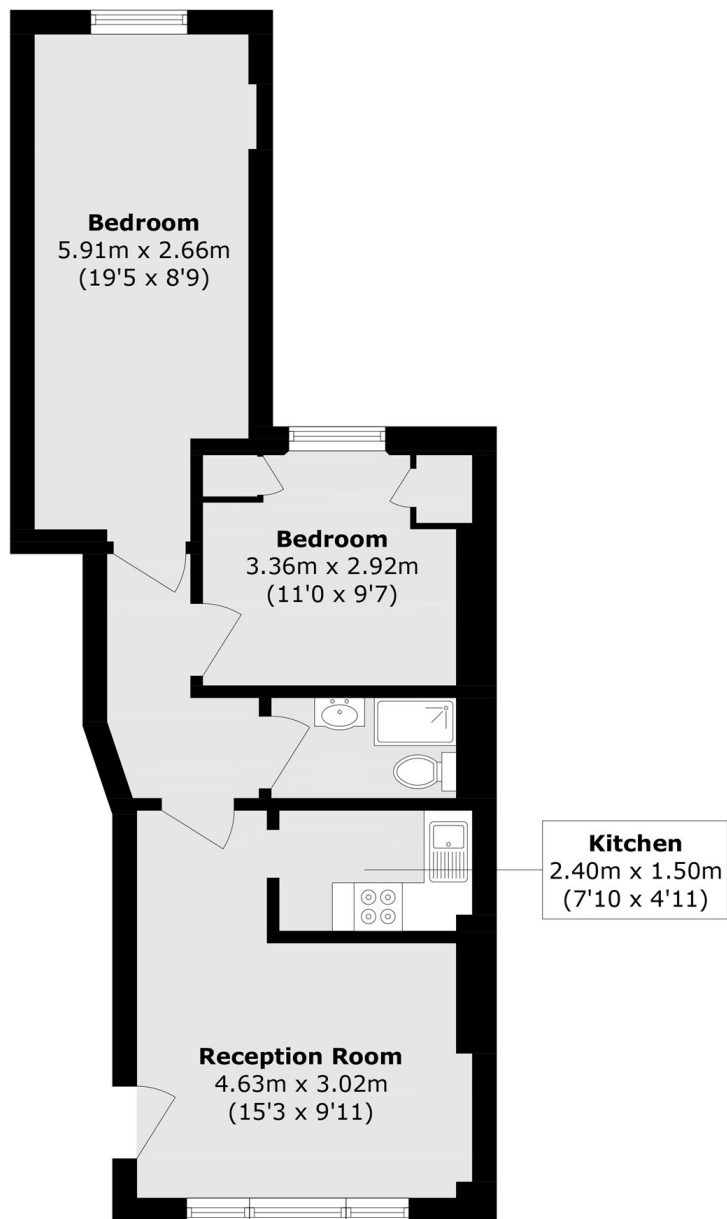

Total area (approx.): 54.7 sq. m (588.7 sq. ft)