



## Portsea Place, W2

£500 Per week

A modern and well presented one bedroom apartment in a portered building with lift access. The property has a large reception, a good size bedroom with storage and hot water and heating is included in the rent.

Portsea Hall is within easy reach of local transport and close to the green open spaces of Hyde Park. The nearest stations are Marble Arch and Edgware Road.

### Features

- One Bedroom
- Portered
- Lift Access
- Wooden Floors
- Hyde Park
- Modern

# Portsea Place, London, W2

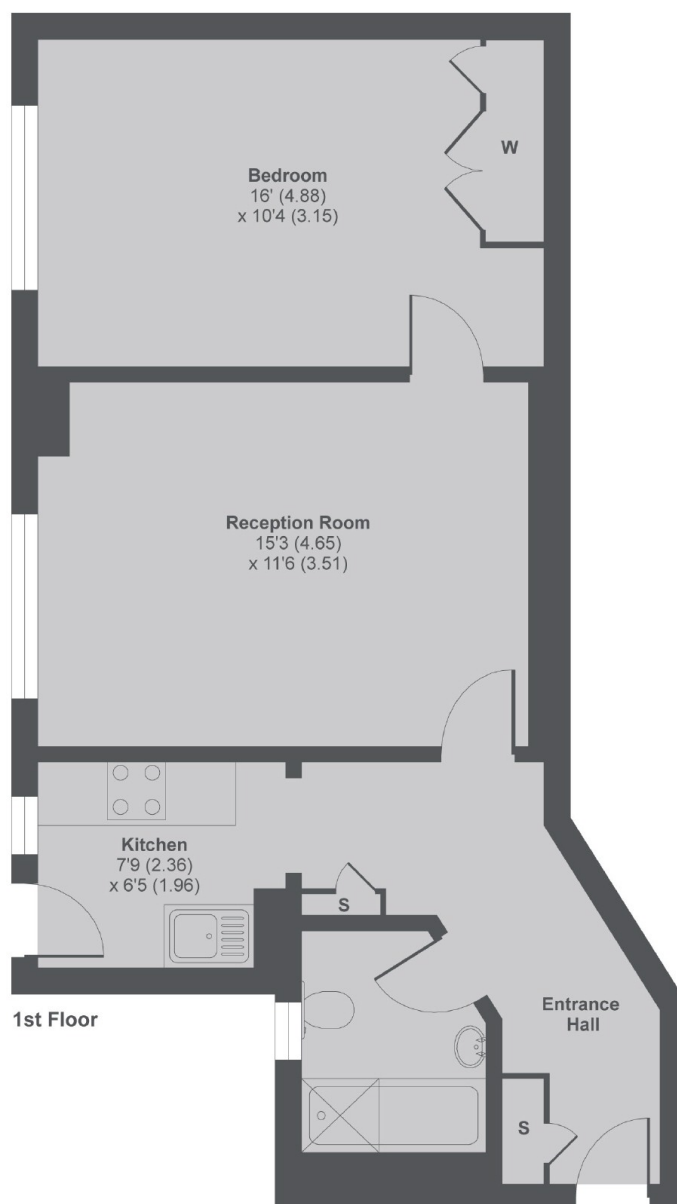

## Portsea Place W2

MAIN HOUSE APPROX FLOOR AREA 539 SQ.FT 50.7 SQ.M  
Copyright nichecom.co.uk 2016 Produced for Dexters REF : 155167

# Dexters

Hyde Park and Bayswater  
4-5 Spring Street  
London  
W2 3RA  
Lettings  
020 7298 1560

Energy Rating: C. We aim to make our particulars both accurate and reliable. However they are not guaranteed; nor do they form part of an offer or contract. If you require clarification on any points then please contact us, especially if you're traveling some distance to view. Please note that appliances and heating systems have not been tested and therefore no warranties can be given as to their good working order.

 **RICS** | Regulated  
Estate Agent  
and Letting Agent

[dexters.co.uk](http://dexters.co.uk)