



## Hatton Garden, EC1N

£3,500 Per calendar month

This two bedroom apartment boasts stylish interiors throughout. Situated on a high floor, the apartment benefits from a private balcony with amazing City views.

Jeygrove Court is ideally located on Hatton Garden and close to Farringdon Station with multiple transport links. There are several supermarkets on the door step as well as the many shops and amenities of nearby Chancery Lane

### Features

Two Bedrooms  
Open Plan Living  
Private Balcony  
Amazing City Views

Hatton Garden,  
London, EC1N

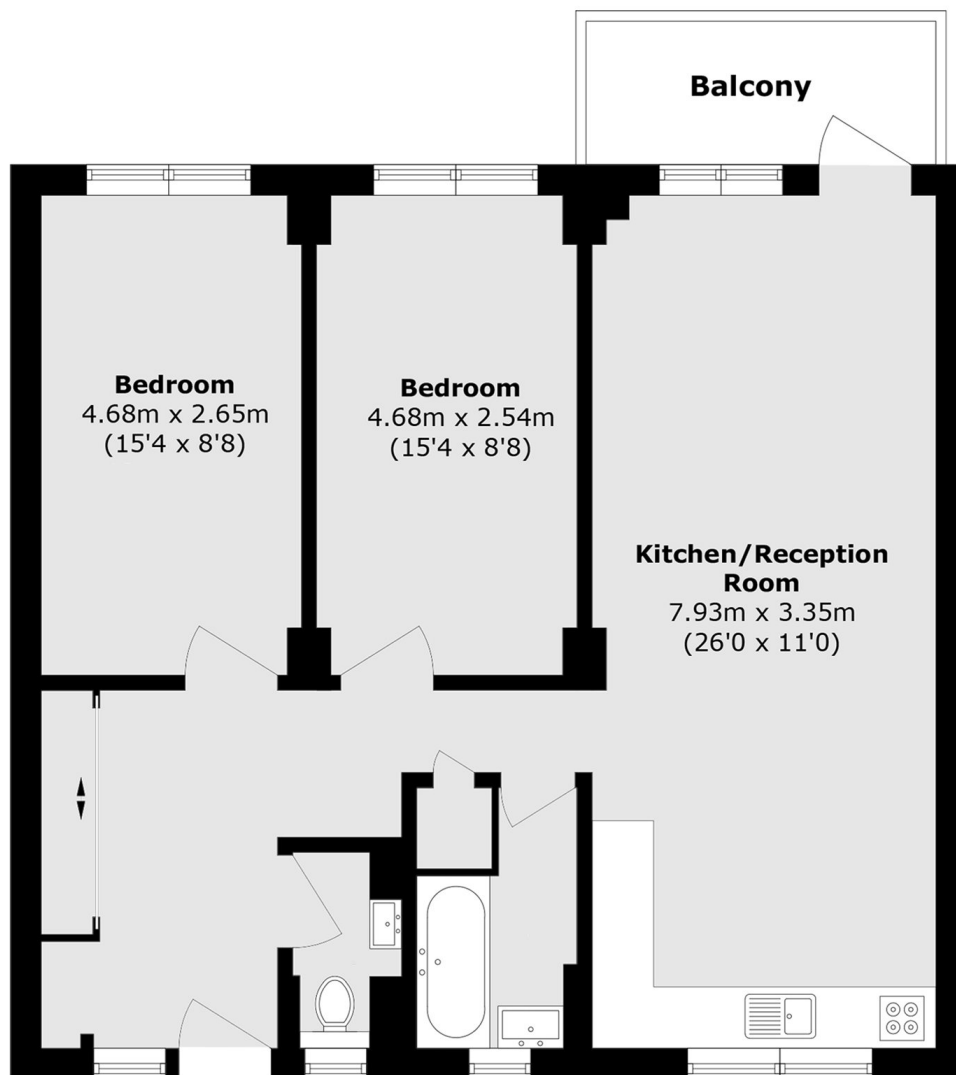

### Eighth Floor

Total area (approx.): 72.5 sq. m (780.3 sq. ft)

Balcony area (approx.): 4.7 sq. m (50.5 sq. ft)

**Dexters**

Clerkenwell  
1b Britton St  
London  
EC1M 5NW  
Lettings  
020 7483 6370

Energy Rating: . We aim to make our particulars both accurate and reliable. However they are not guaranteed; nor do they form part of an offer or contract. If you require clarification on any points then please contact us, especially if you're traveling some distance to view. Please note that appliances and heating systems have not been tested and therefore no warranties can be given as to their good working order.

 **RICS** | Regulated  
Estate Agent  
and Letting Agent

[dexters.co.uk](http://dexters.co.uk)