



Hampton Road, TW12

£799,950

On the borders of Teddington, this house has an absolutely stunning finish. Combine this with the location, with gates into Bushy Park a short walk away, it is a three bedroom home that you need to come and see!

On the corner of Laurel Road and Hampton Road, centrally located for Fulwell Station and the many local shops and cafés of Hampton Hill and Teddington. There is easy access to both Twickenham and the A316, whilst gates to Bushy Park are around the corner.

Features

- Three Bedrooms
- Two Bathrooms
- Sought-after Location
- Close To The Park
- Teddington Borders
- South Facing Garden

Hampton Road, Hampton Hill, TW12

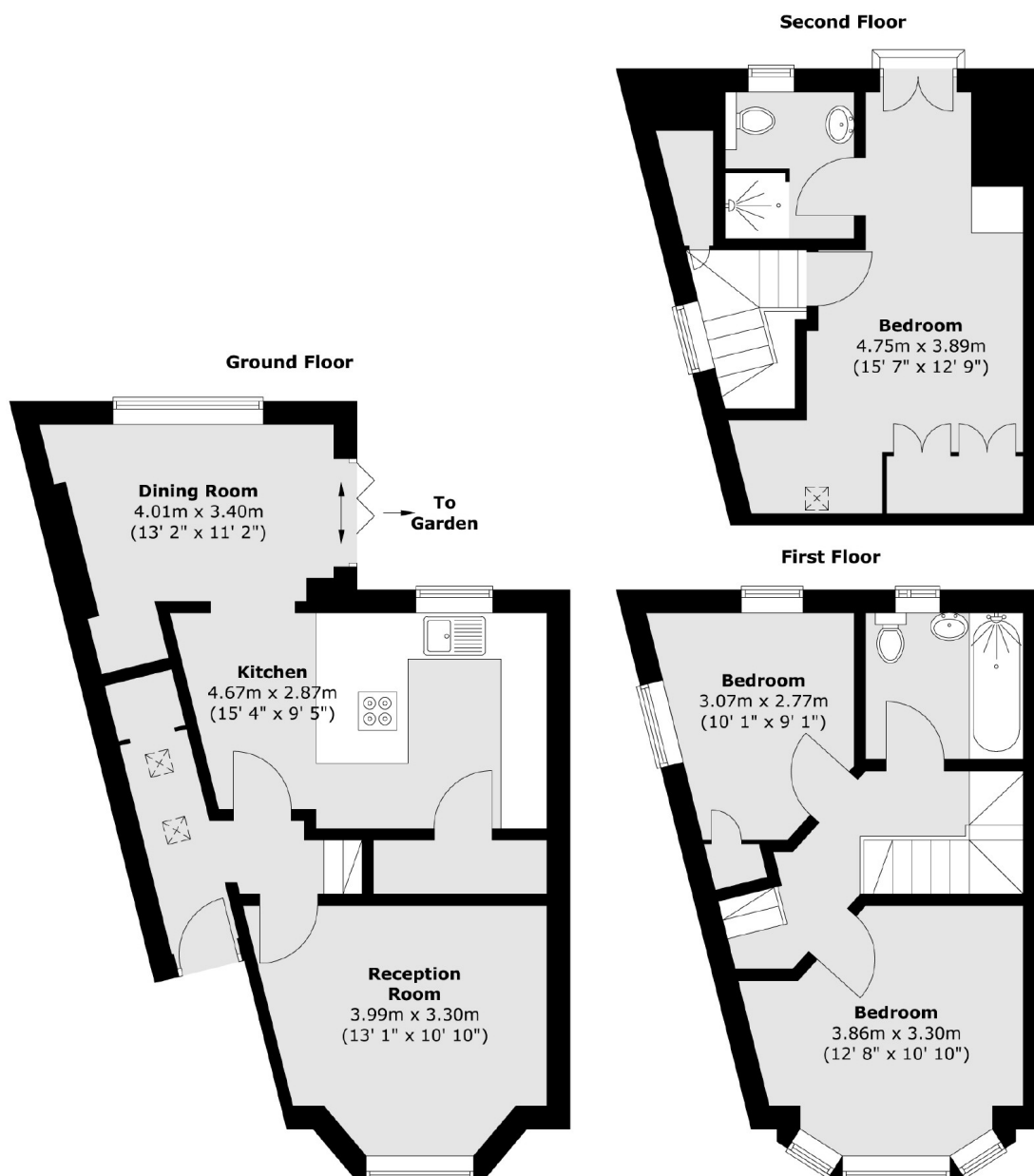

Total area (approx.) : 95.1 sq. m (1024 sq. ft)
Total balcony area (approx.) : 0.2 sq. m (2 sq. ft)

Dexters

Hampton
93 Station Road
Hampton
TW12 2BD
Sales
020 8255 7777

Energy Rating: C. We aim to make our particulars both accurate and reliable. However they are not guaranteed; nor do they form part of an offer or contract. If you require clarification on any points then please contact us, especially if you're traveling some distance to view. Please note that appliances and heating systems have not been tested and therefore no warranties can be given as to their good working order.

 **RICS** | Regulated
Estate Agent
and Letting Agent

[dexters.co.uk](https://www.dexters.co.uk)