



Evelyn Crescent, TW16

£530,000

Immaculately presented, this extended end-of-terrace, three-bedroom, two-bathroom property provides off-street parking, a garage (currently used as a fully functioning gym) and a large rear garden, complete with mature trees, patio area and newly fitted fencing. Spacious and light, this beautiful family home features clean, contemporary decor throughout - ready for the new owner to move straight in.

Evelyn Crescent is located off Nursery Road and is conveniently close to local schools, supermarkets, just a short walk from the picturesque River Thames. Nearby, Upper Halliford and Sunbury stations provide a direct service to London Waterloo.

Features

- Three Bedrooms
- Extended Ground Floor
- Two Bathrooms
- Large Rear Garden
- Off-Street Parking
- Potential to Extend (STPP)

Evelyn Crescent, Sunbury-On-Thames, TW16

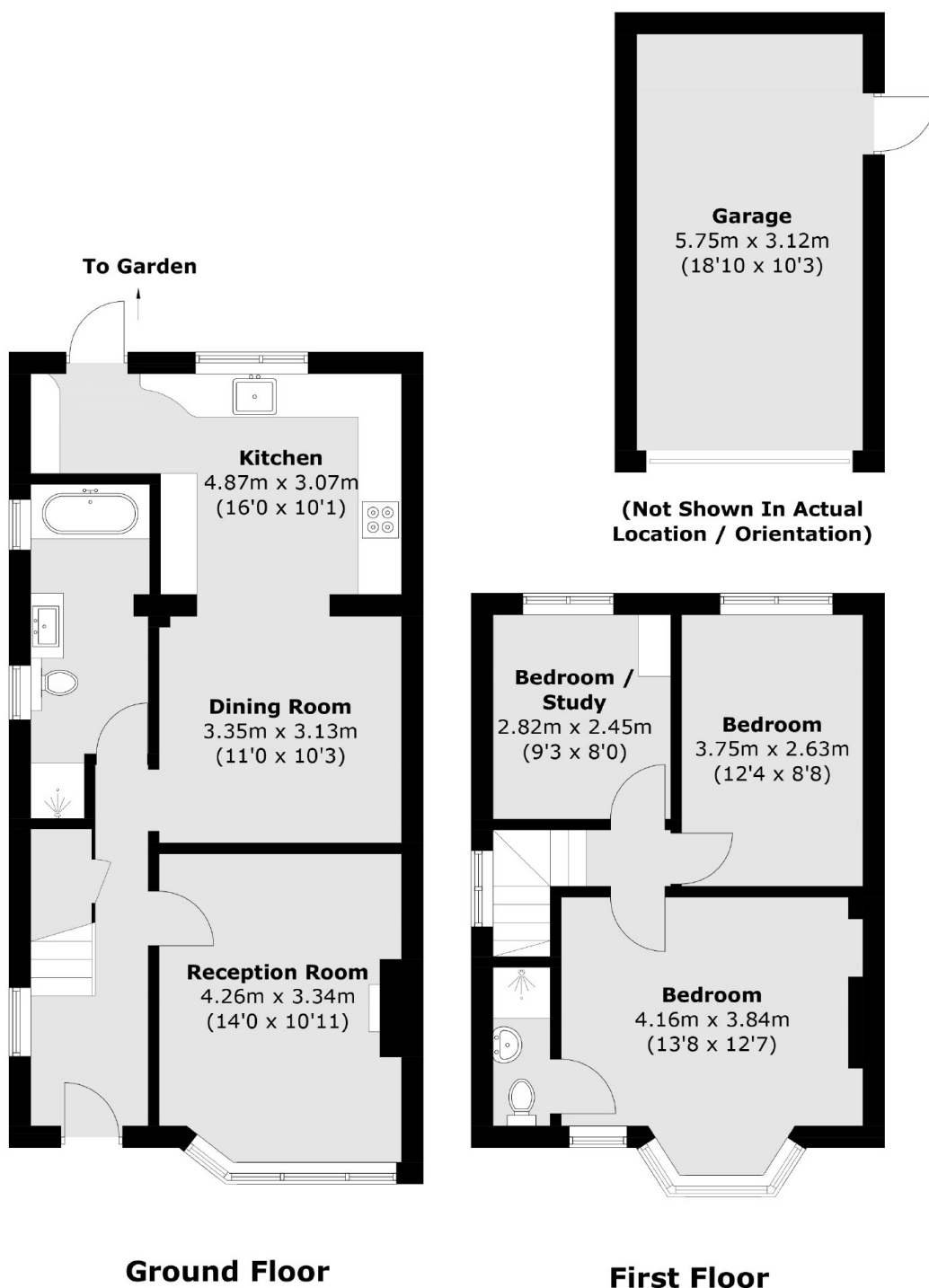

Total area (approx.): 91.8 sq. m (988.1 sq. ft)
Garage: 18.1 sq. m (194.8 sq. ft)

Dexters

Sunbury
22 Thames Street
Sunbury-On-Thames
TW16 6AF
Sales
01932 781100

Energy Rating: D. We aim to make our particulars both accurate and reliable. However they are not guaranteed; nor do they form part of an offer or contract. If you require clarification on any points then please contact us, especially if you're traveling some distance to view. Please note that appliances and heating systems have not been tested and therefore no warranties can be given as to their good working order.

 **RICS** | Regulated
Estate Agent
and Letting Agent

dexters.co.uk