



International Way, TW16

£285,000

A well presented two bedroom, two bathroom ground floor apartment with direct access on to a private patio. This lovely apartment has the added bonus of allocated parking and use of the communal gardens with the development.

International Way is a gated development under half a mile from Upper Halliford station, which provides a direct service into London Waterloo.

Features

- Two Bedrooms
- Two Bathrooms
- Ground Floor
- Allocated Parking
- Communal Gardens
- Gated Development

International Way, Sunbury-On-Thames, TW16

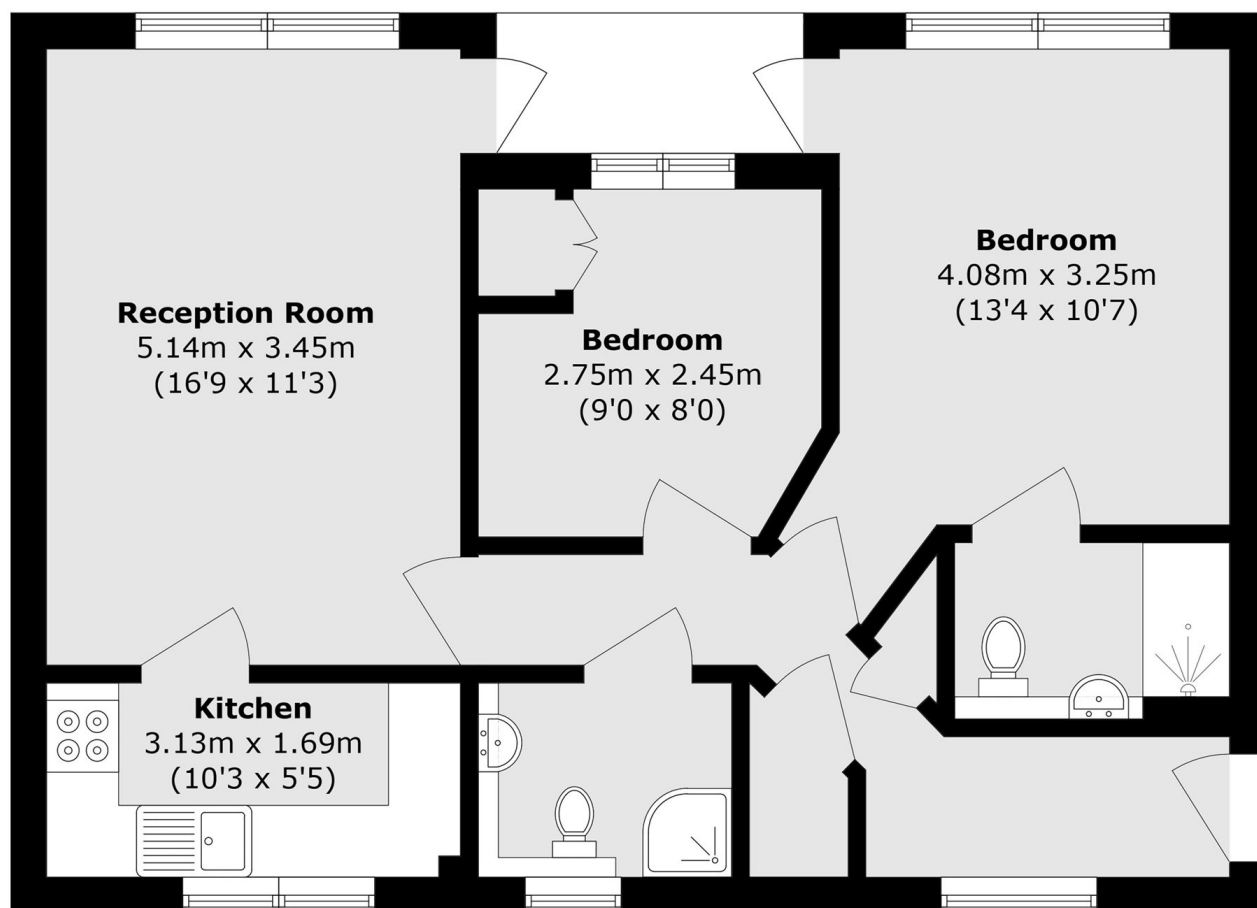

Total area (approx.): 64.4 sq. m (693.2 sq. ft)