



**Tolworth Rise North, KT5**

**£675,000**

**Dexters**



## Tolworth Rise North, KT5

An immaculately presented three/ four bedroom, two bathroom, ground floor extended 1930s house, offering over 1500sqft of accommodation, off street parking and a lovely secluded rear garden.

On the ground floor this property offers a large bay fronted reception room, a second reception room leading onto the dining room and a newly refurbished kitchen and utility space.

On the first floor there are three bedrooms and a bathroom all presented to a high standard. There are huge development opportunities to build another bedroom on top of the garage and to extend into the loft ( STPP).

At the front there is a driveway for 2/3 cars and to the rear there is a lovely private garden with the start of an office/annex being built.

Nearby are plenty of shops and some great schools. Tolworth station 0.3miles away with links to Raynes Park, Clapham Junction & London Waterloo and Surbiton high street is a short bus ride away.

### Features

- Semi Detached
- Three/ Four Bedrooms
- Family Home
- Off Street Parking
- Rear Garden
- Potential To Extend (STPP)















# Tolworth Rise North, Surbiton, KT5

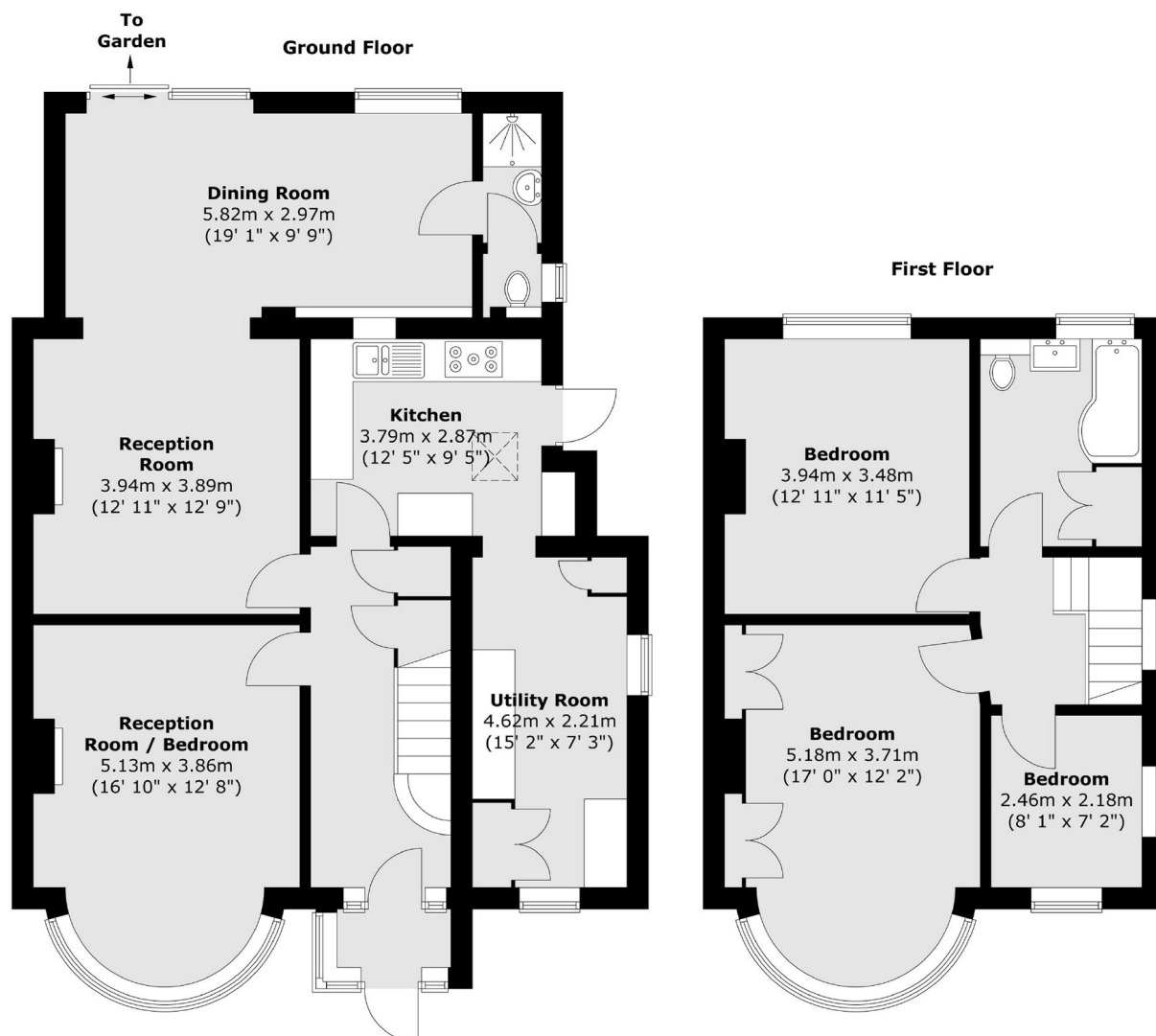

Total area (approx.) : 141.2 sq. m (1520 sq. ft)