



Anglers Reach, KT6
£660,000

Dexters



Anglers Reach, KT6

An exceptionally bright and generously proportioned apartment, offering breathtaking panoramic views across the River Thames, Home Park, and the scenic landscape beyond. This property has been professionally interior designed throughout and offers two double bedrooms a large reception room, smart kitchen, immaculate bathroom and a garage.

This elegant residence boasts over 900 sq ft of beautifully arranged living space, including a grand double reception room with dual-aspect windows that flood the space with natural light and frame the stunning riverside vistas. The stylish, well-appointed kitchen is thoughtfully designed for both functionality and comfort, while the expansive principal bedroom has a sense of refined indulgence. A second spacious double bedroom and a beautifully finished bathroom complete the interior accommodation. Situated within an exclusive development, the apartment further benefits from lift access, a garage and comes with a valuable share of the freehold offering both convenience and long-term security. This is riverside living at its most sophisticated.

Anglers Reach is a popular block situated in one of Surbiton's most attractive sought after tree-lined roads. Surbiton's high street and mainline station are both within 0.5 miles and the River Thames is on your doorstep. Kingston with its array of restaurants and shops is within half a mile.

Features

- River Side Apartment
- Two Double Bedrooms
- Stunning River Views
- Over 900 Sq Ft
- Close to Station
- Garage







Anglers Reach, Surbiton, KT6

Sixth Floor

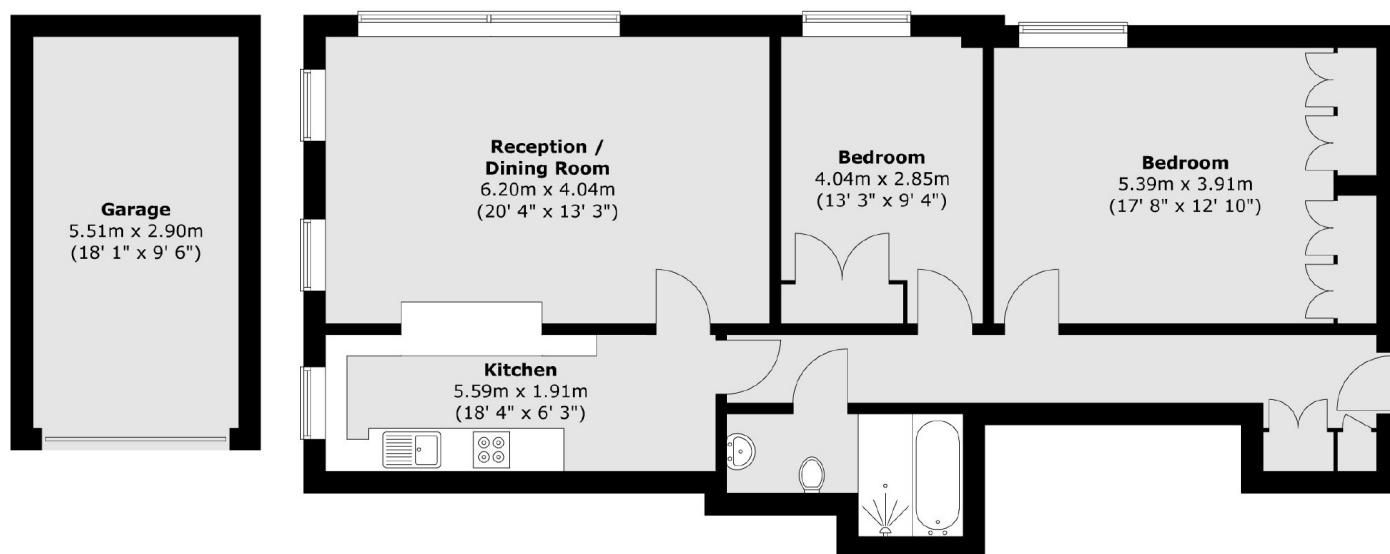

Total area (approx.) : 87.6 sq. m (943 sq. ft)
Total garage area (approx.) : 16 sq. m (172 sq. ft)