



## Strathleven Road, SW2

£2,750 Per calendar month

This charming and well-proportioned two bedroom, one bathroom terraced property sits on popular Strathleven Road. Inside, you'll find a comfortable living area filled with natural daylight, space for dining and a stylish kitchen, equipped with essential appliances.

Strathleven Road is perfectly located for the shops, restaurants and amenities of Acre Lane. Transport links include, Brixton railway and underground and Clapham North underground station.

### Features

- Two Double Bedrooms
- Full House
- Spacious Reception Room
- Stylish Kitchen
- Private Decked Garden
- Close To Transport





## Strathleven Road, SW2

Offered unfurnished, the space allows you to create a home that reflects your own taste.

The property has been finished to a modern standard throughout and includes a private garden, which provides a pleasant spot for outdoor enjoyment and hosting friends.





# Strathleven Road, London, SW2

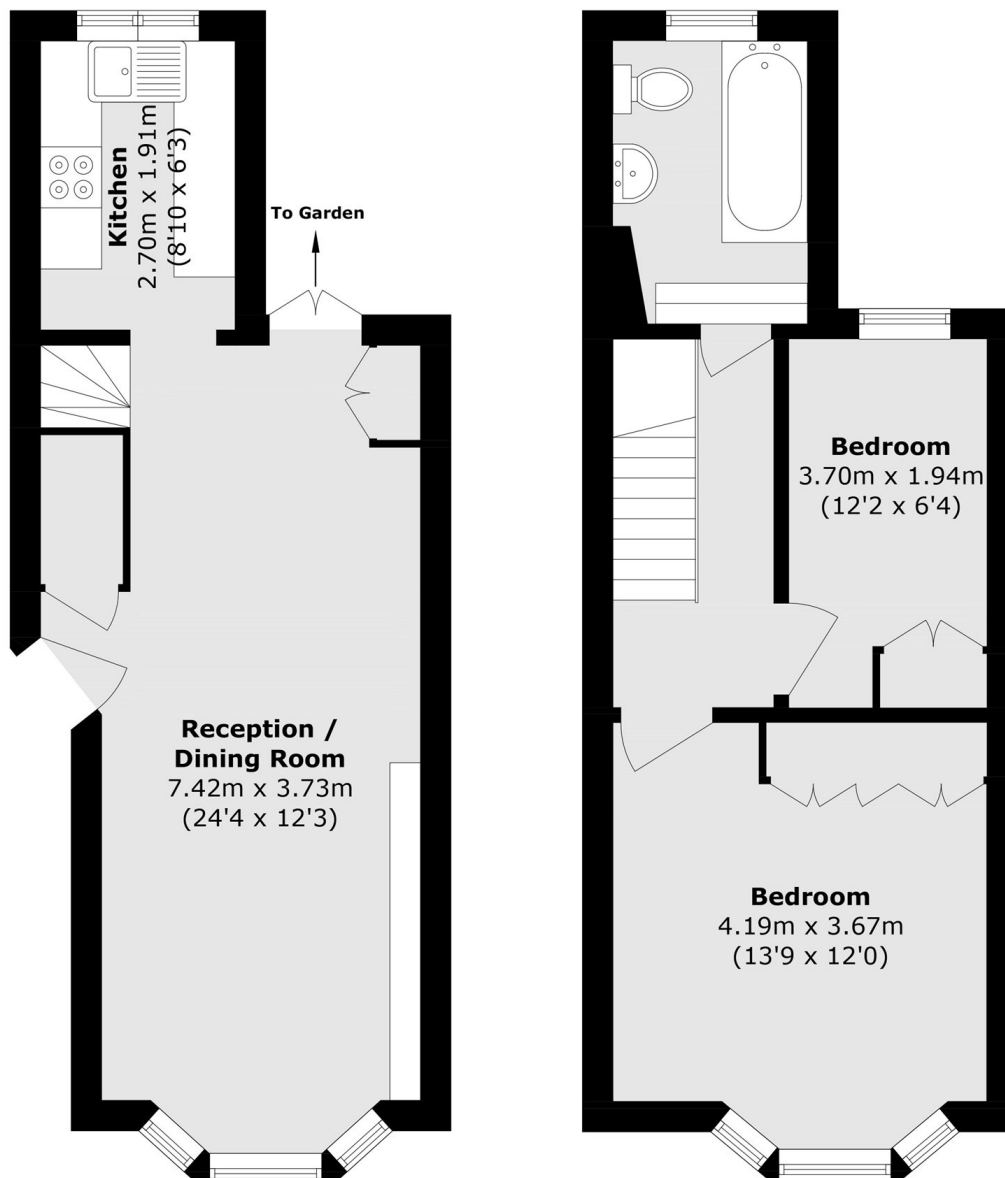

Total area (approx.): 65.6 sq. m (706.1 sq. ft)