



Earl's Court Square, SW5

£807 Per week

A recently renovated two bedroom flat overlooking Earl's Court Square with its own balcony. The flat has high ceilings which are utilised by all the storage throughout and a fully equipped kitchen.

Earl's Court Square is conveniently located between Earl's Court Road and Warwick Road and provides an array of shops, restaurants and bars within close proximity. The nearest Underground Station is Earl's Court and provides great transport links into central London.

Features

- Two Bedrooms
- One Bathroom
- High Ceilings
- Herringbone Flooring
- Storage
- Balcony

Earl's Court Square, London, SW5

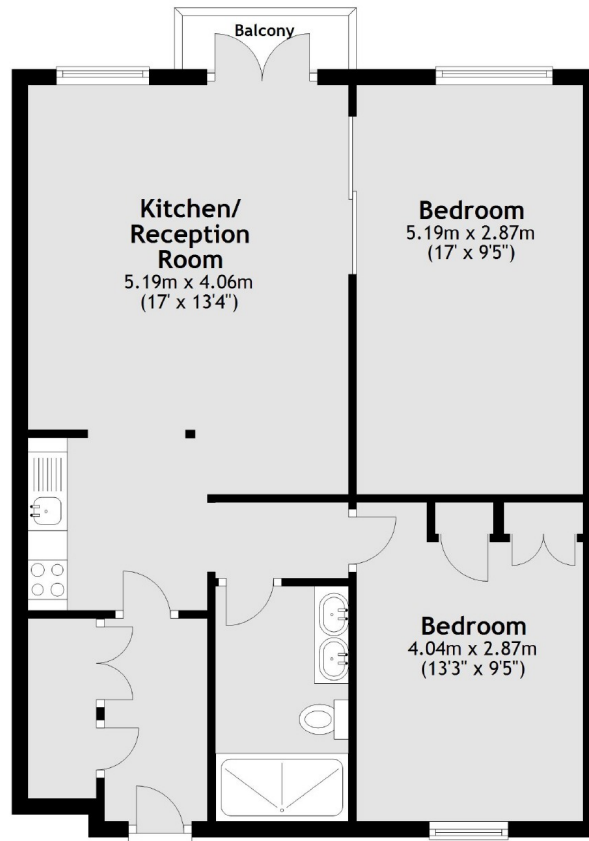

Main area: Approx. 65.4 sq. metres (703.9 sq. feet)
Plus balcony, approx. 1.6 sq. metres (17.7 sq. feet)

Dexters

Earl's Court
3 Hogarth Place
London
SW5 0QT
Lettings
020 7370 3030

Energy Rating: . We aim to make our particulars both accurate and reliable. However they are not guaranteed; nor do they form part of an offer or contract. If you require clarification on any points then please contact us, especially if you're traveling some distance to view. Please note that appliances and heating systems have not been tested and therefore no warranties can be given as to their good working order.

 **RICS** | Regulated
Estate Agent
and Letting Agent

[dexters.co.uk](https://www.dexters.co.uk)