



Holland Road, W14

£450,000

A spacious one bedroom apartment on the third floor of a beautiful Victorian townhouse. This property has large living room with separate kitchen, 17ft double bedroom, bathroom, sash windows and plenty of storage.

This property is located between Kensington Olympia and the green space of Holland Park. Westfield Shopping Centre is nearby and there are many transport links including the Central Line, Overground and District.

Features

- One Bedroom
- Victorian Conversion
- Fantastic Location
- Separate Kitchen
- RBKC
- Central Line

Holland Road, London, W14

Third Floor

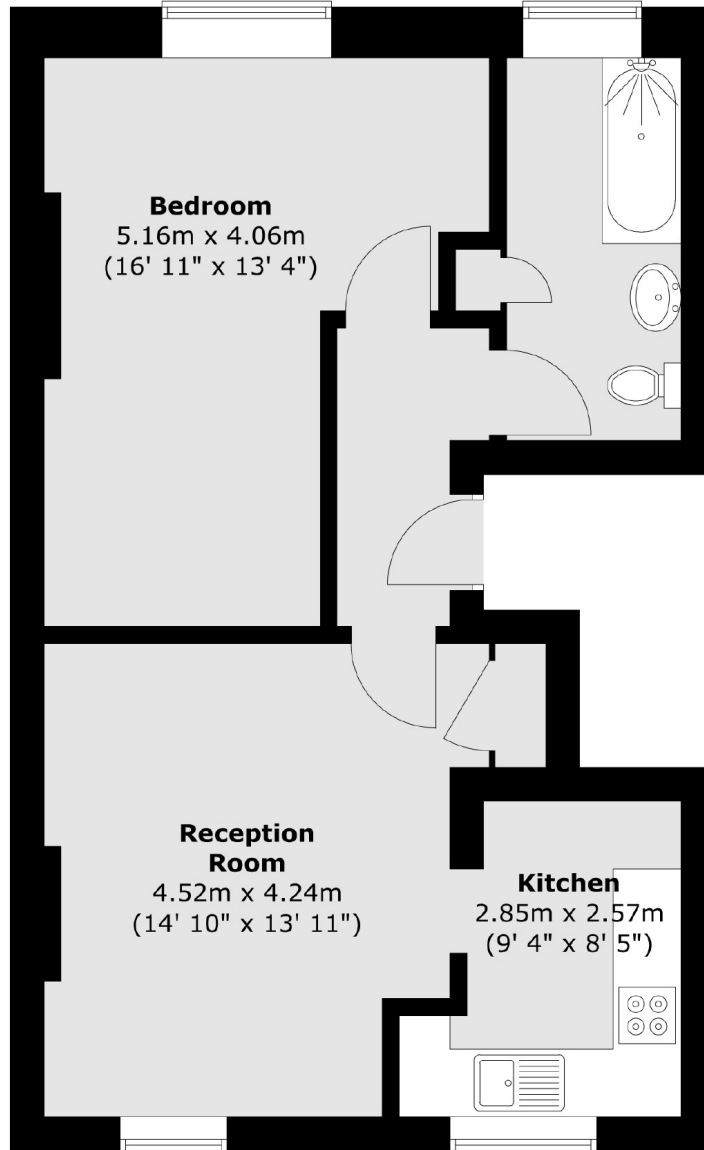

Total area (approx.) : 49.4 sq. m (532 sq. ft)