



Blythe Road, W14

£519 Per week

A bright 1-bed flat in the popular Kensington West (W14) development, featuring an spacious reception area, a fully fitted kitchen, a large bedroom and a contemporary bathroom.

Kensington West is a 24 hour portered private development situated within close proximity of both Holland Park and High Street Kensington.

Features

- One Bedroom
- Ample Storage
- 24 Hour Concierge
- Secure Development
- Gymnasium
- Swimming Pool

Blythe Road,
London, W14

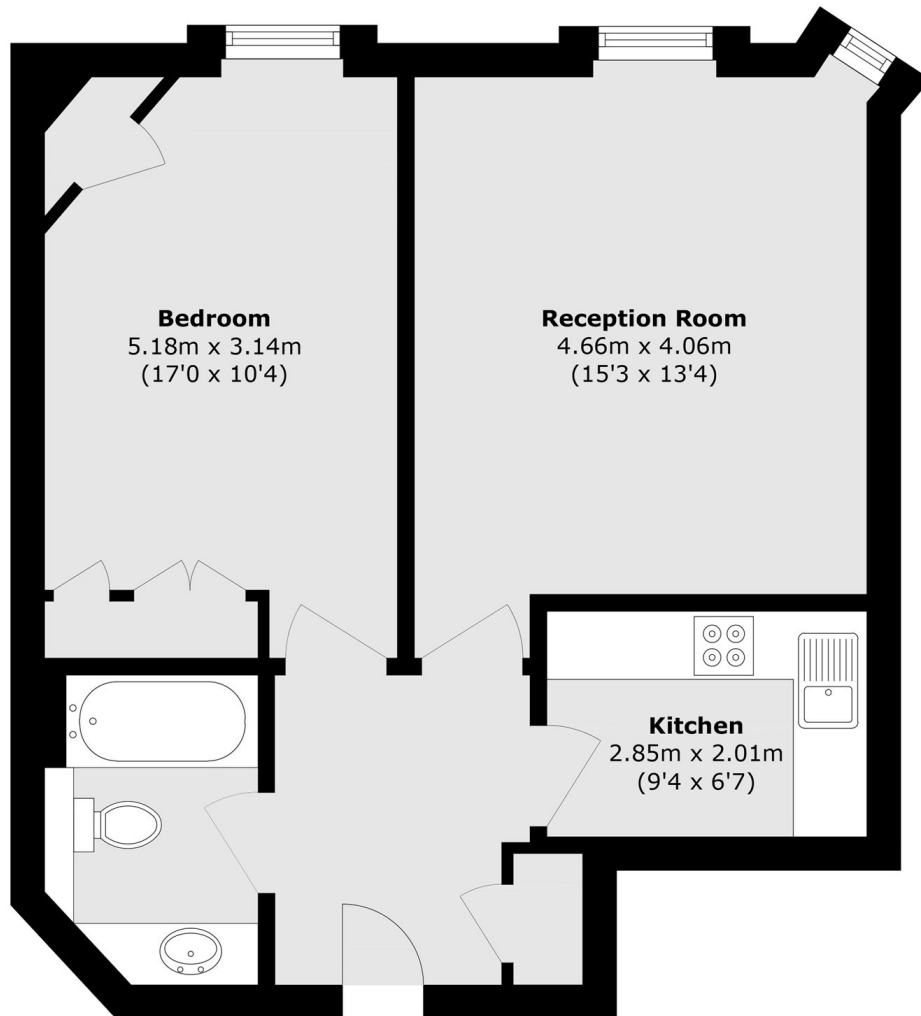

Total area (approx.): 55.9 sq. m (601.7 sq. ft)

Dexters

Shepherds Bush and Brook Green
53 Shepherds Bush Green
London
W12 8PS
Lettings
020 8723 8899

Energy Rating: C. We aim to make our particulars both accurate and reliable. However they are not guaranteed; nor do they form part of an offer or contract. If you require clarification on any points then please contact us, especially if you're traveling some distance to view. Please note that appliances and heating systems have not been tested and therefore no warranties can be given as to their good working order.

 **RICS** | Regulated
Estate Agent
and Letting Agent

dexters.co.uk