



Jeddo Road, W12

£784 Per week

This recently refurbished three double bedroom split level maisonette, which has recently been neutrally decorated throughout and benefits from an extra study room, separate kitchen leading onto a private garden.

Jeddo Road is located just under a mile from Stamford Brook Station and one mile from the local amenities of Chiswick High Road. Also, close to Askew Road and a few minutes walk from Wendell Park.

Features

- Victorian Conversion
- Three Double Bedrooms
- Separate Kitchen
- Study Room
- Recently Refurbished
- Private Garden

Jeddo Road,
London, W12

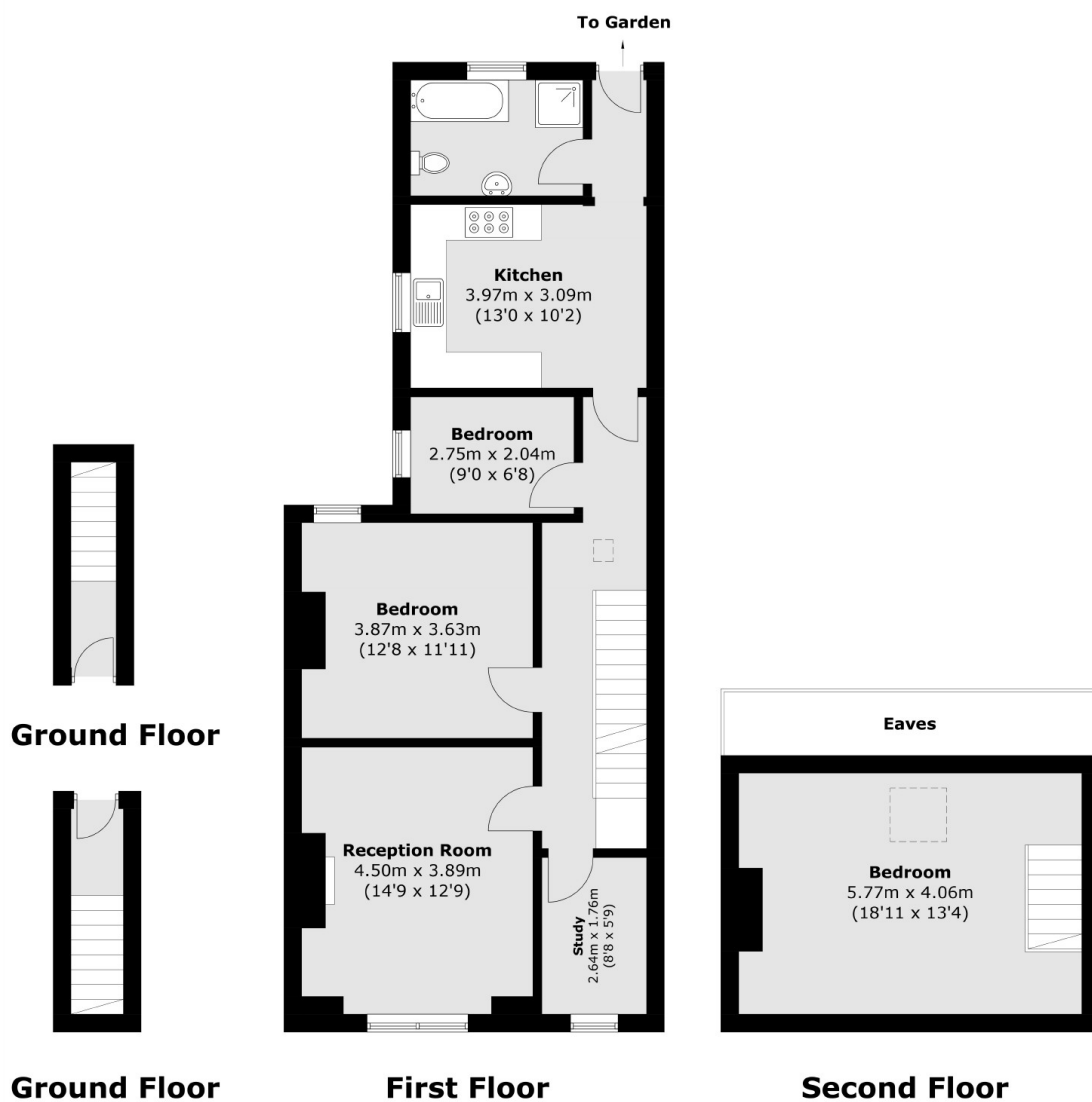

Total area (approx.): 107.0 sq. m (1,151.8 sq. ft)
(Excluding Eaves)

Dexters

Shepherds Bush and Brook Green
53 Shepherds Bush Green
London
W12 8PS
Lettings
020 8723 8899

Energy Rating: D. We aim to make our particulars both accurate and reliable. However they are not guaranteed; nor do they form part of an offer or contract. If you require clarification on any points then please contact us, especially if you're traveling some distance to view. Please note that appliances and heating systems have not been tested and therefore no warranties can be given as to their good working order.

RICS Regulated
Estate Agent
and Letting Agent

dexters.co.uk