

Westway, W12

£600,000

A three double bedroom end of terrace house. The property comprises of a spacious living room and kitchen on the ground floor with a garden to the rear and family bathroom. The property benefits from double glazing and central heating and is centrally located so has easy access to the city or out of London via the Westway.

The Westway (A40) presents easy access into the City of London and west out of London. Local amenities are situated nearby on Old Oak Common Lane, including shops and restaurants. Public transport links are accessed via East Acton tube station (Central line). There are also a number of bus routes which take you into the city.

Features

- Freehold
- Three Double Bedrooms
- Bright and Spacious
- Private Garden
- Central Location
- No Onward Chain

Westway, London, W12

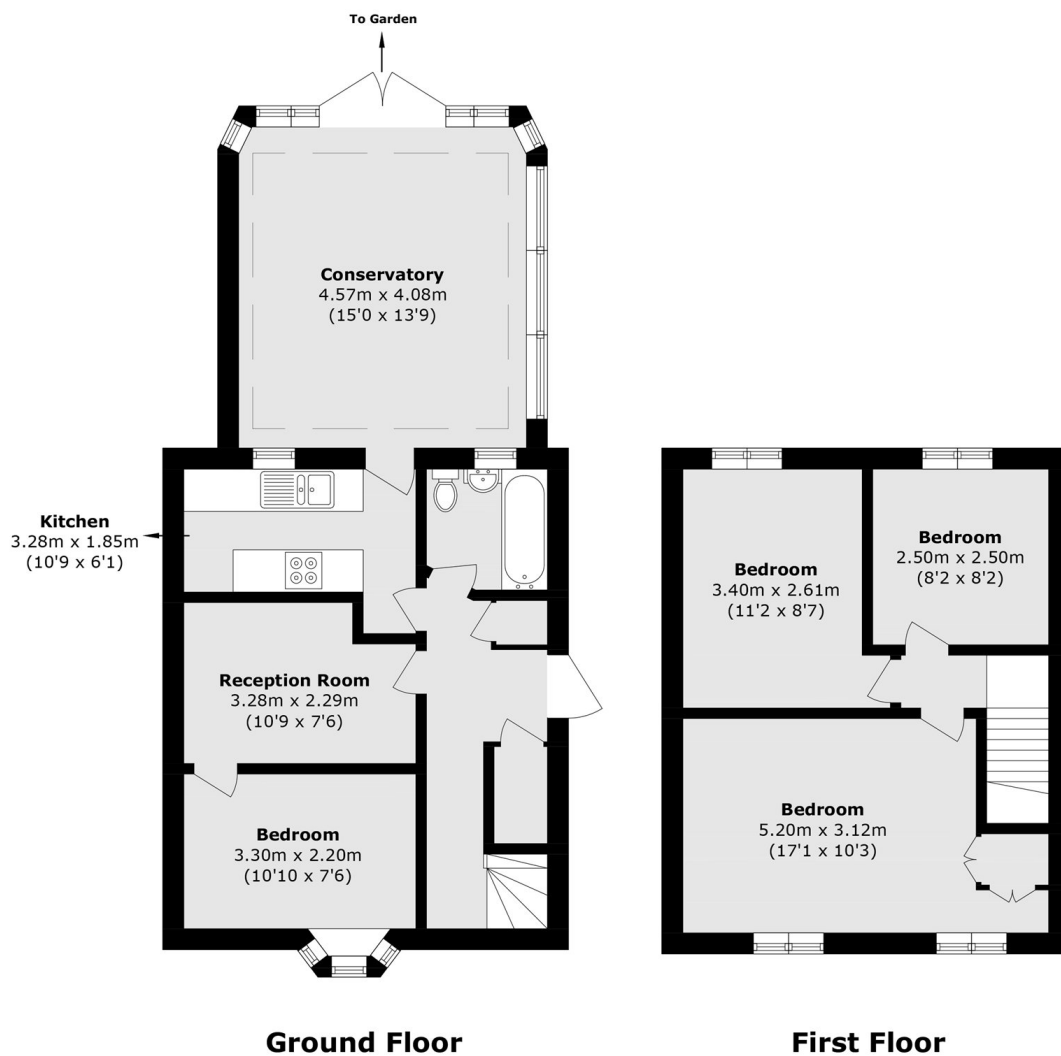

Total area (approx.): 88.3 sq. m (950.4 sq. ft)

Dexters

Shepherds Bush and Brook Green
53 Shepherds Bush Green
London
W12 8PS
Sales
020 8740 2900

Energy Rating: D. We aim to make our particulars both accurate and reliable. However they are not guaranteed; nor do they form part of an offer or contract. If you require clarification on any points then please contact us, especially if you're traveling some distance to view. Please note that appliances and heating systems have not been tested and therefore no warranties can be given as to their good working order.

 **RICS** | Regulated
Estate Agent
and Letting Agent

[dexters.co.uk](https://www.dexters.co.uk)