



## White City Estate, W12

### £380,000

A modern and bright, top-floor, purpose-built flat located on the edge of the White City Estate. The property was completely refurbished to a high standard approximately eight years ago, including full rewiring and re-plumbing, a brand-new kitchen, and a new bathroom and separate WC. The flat is presented in very good condition and features recessed spotlights throughout and pale grey wooden flooring with acoustic underlay. Accommodation comprises a large sitting room, three generous double bedrooms (two with built-in wardrobes).

Mackay House is close to Westfield White City, BBC Centre, numerous shops, restaurants and bars. Sainsbury's and Wormholt Park are moments away. It is ideally located, providing easy access to the A40 and transport into Central London. Transport links are excellent with Central and Hammersmith & City Line tubes and many buses.

### Features

- Three Bedroom
- Separate Kitchen/Living
- Built In Storage
- HMO Licensed
- Residents Parking
- No Onward Chain

# White City Estate, London, W12

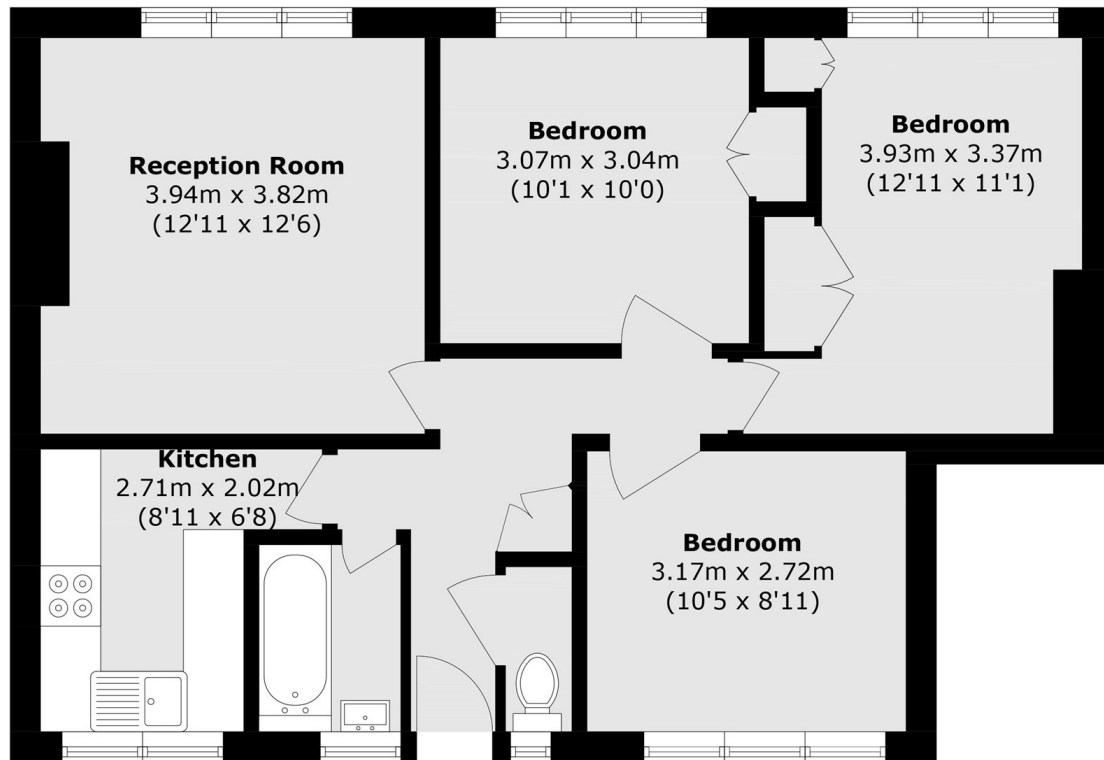

Total area (approx.): 66.2 sq. m (712.5 sq. ft)