



## Prebend Street, N1

£425,000

Set in a prime Islington location, this one bedroom apartment is set on the first floor of a purpose built development. There are wooden floors throughout, and the semi-open plan kitchen/living room is filled with natural light.

Isleden House is located on Prebend Street, on the cusp of the Arlington Conservation area. Essex Road station (Great Northern Line) is a quarter mile away for direct links to Moorgate, and Angel station (Northern) is around three quarters of a mile.

### Features

- One Bedroom
- First Floor
- Semi-open Plan
- Permit Parking
- Fitted Storage

# Prebend Street, London, N1

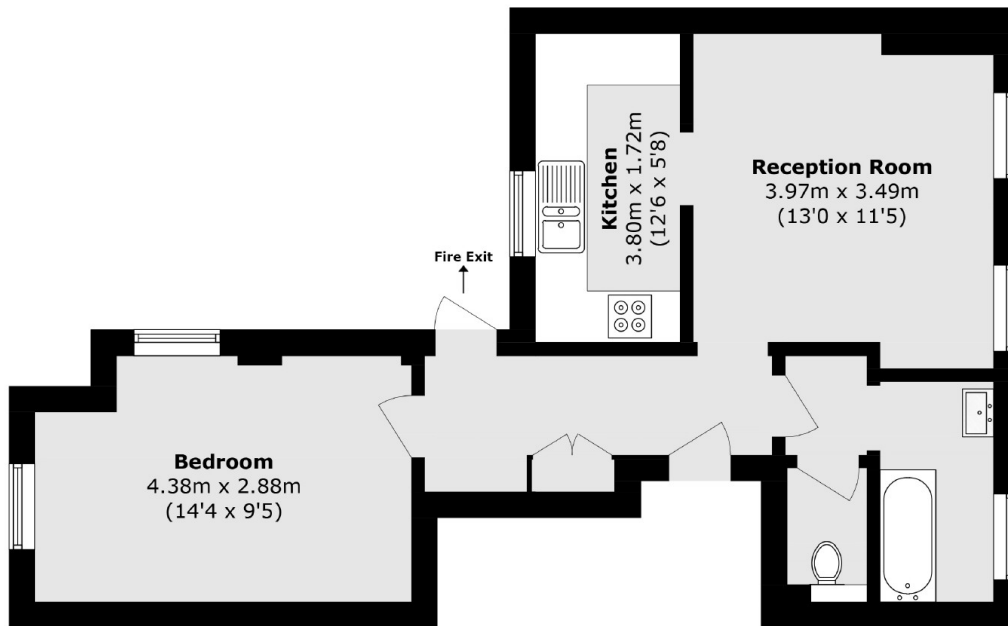

Total area (approx.): 44.9 sq. m (483.3 sq. ft)