



## Barnsbury Road, N1

### £250,000

Offered chain-free, this charming one-bedroom top-floor apartment is perfectly positioned in the heart of Barnsbury. Set in a handsome period building, the apartment offers a well-designed layout featuring an open-plan kitchen/living area with a bright westerly aspect, a bright and peaceful double bedroom, neat family bathroom and ample built-in storage.

The location is unbeatable - just moments from the vibrant Upper Street, with an abundance of restaurants, bars, and independent shops and access to Chapel Market. Barnsbury Park and the scenic Regent's Canal are also nearby, offering green spaces for leisure and relaxation. Excellent transport links are available with Angel Underground Station (Northern Line) and King's Cross/St Pancras just a short distance away.

### Features

- Period Conversion
- One Bedroom Apartment
- Top Floor
- Chain Free
- Leasehold
- 91 Year lease
- 459 Square Feet

# Barnsbury Road, London, N1

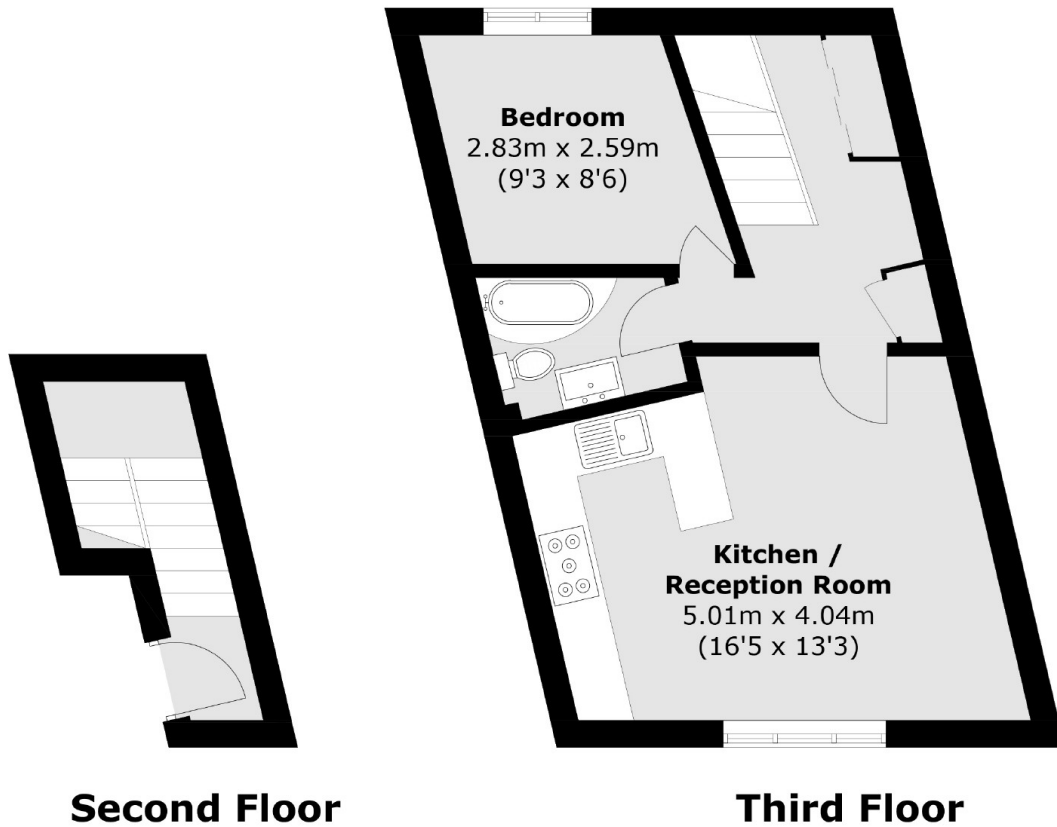

Total area (approx.): 42.7 sq. m (459.6 sq. ft)