



## Southgate Road, N1

### £600,000

A two double bedroom, two bathroom apartment on the sixth floor of a purpose built development. It has an open plan kitchen and living room with floor to ceiling windows, private balcony, 24 hour gym and access to a communal Japanese garden.

Located at the Southerly end of De Beauvoir, this property has the ideal combination of being in a residential, neighbourly area, whilst also having excellent links to The City and beyond. Rosemary Gardens are opposite, and Shoreditch Park is just South of Regents Canal for Green Space. For transport, Haggerston is just half a mile away, and regular buses provide access to Old Street (Northern Line).

### Features

- Two Double Bedrooms
- Two Bathrooms
- Balcony
- 24 Hour Concierge
- Gym, Steam Room & Sauna
- Communal Japanese Garden

# Southgate Road, London, N1

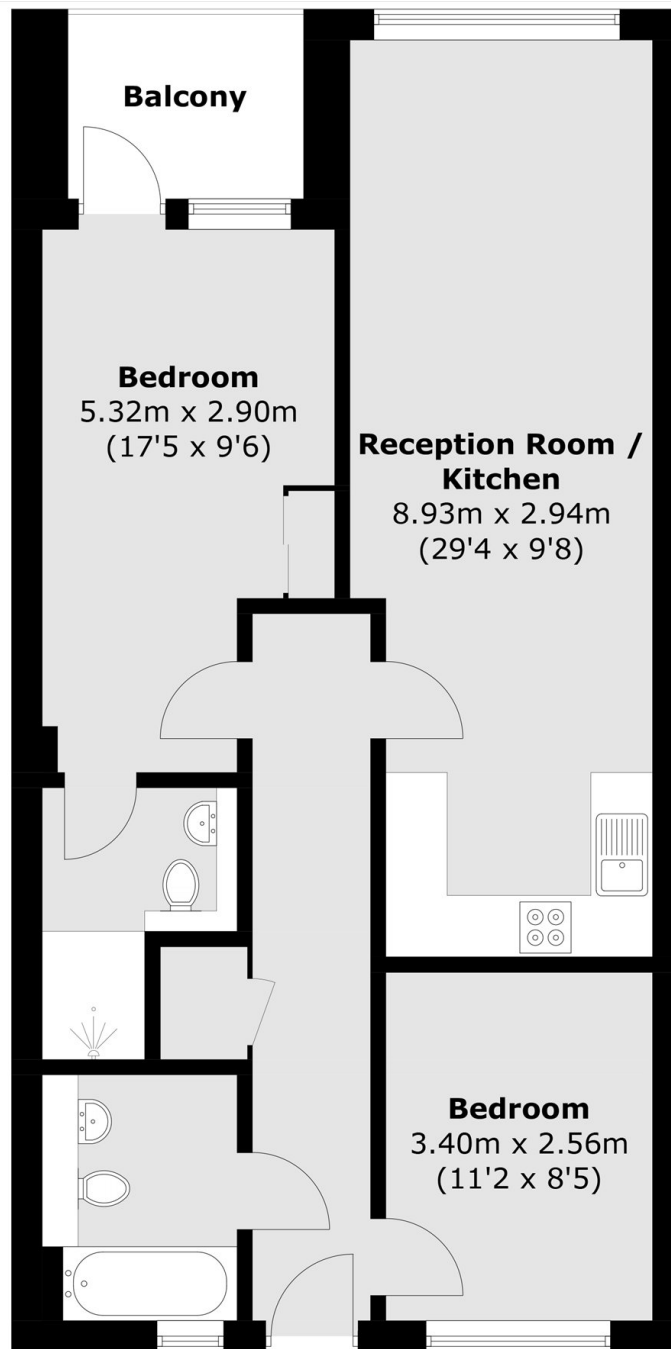

Total area (approx.): 69.1 sq. m (743.8 sq. ft)  
Balcony : 4.1 sq. m (44.1 sq. ft)

## Dexters

Islington  
76 Upper Street  
London  
N1 0NU  
Sales  
020 7483 6373

Energy Rating: C. We aim to make our particulars both accurate and reliable. However they are not guaranteed; nor do they form part of an offer or contract. If you require clarification on any points then please contact us, especially if you're traveling some distance to view. Please note that appliances and heating systems have not been tested and therefore no warranties can be given as to their good working order.

 **RICS** | Regulated  
Estate Agent  
and Letting Agent

[dexters.co.uk](https://www.dexters.co.uk)