

## Buckler Court, N7

### £650,000

A substantial two bedroom apartment on the top floor of a purpose built development in Lower Holloway. This well presented home has a large, light filled open plan living space, leading directly out to a South West facing balcony. The development also benefits from on-site 24-hour concierge, landscaped communal gardens and a communal gym.

Buckler Court is within the Vizion7 Development in Eden Grove. Superbly situated for transportation as Holloway Road Underground (Piccadilly Line) is a stone's throw away. Access to Highbury and Islington (Victoria Line and Overground) and Drayton Park Station (Great Northern) is also within reach.

### Features

- Two Bedrooms
- Two Bathrooms
- Top Floor
- Secure Allocated Parking
- South West Facing Balcony
- Long Lease

# Buckler Court, London, N7

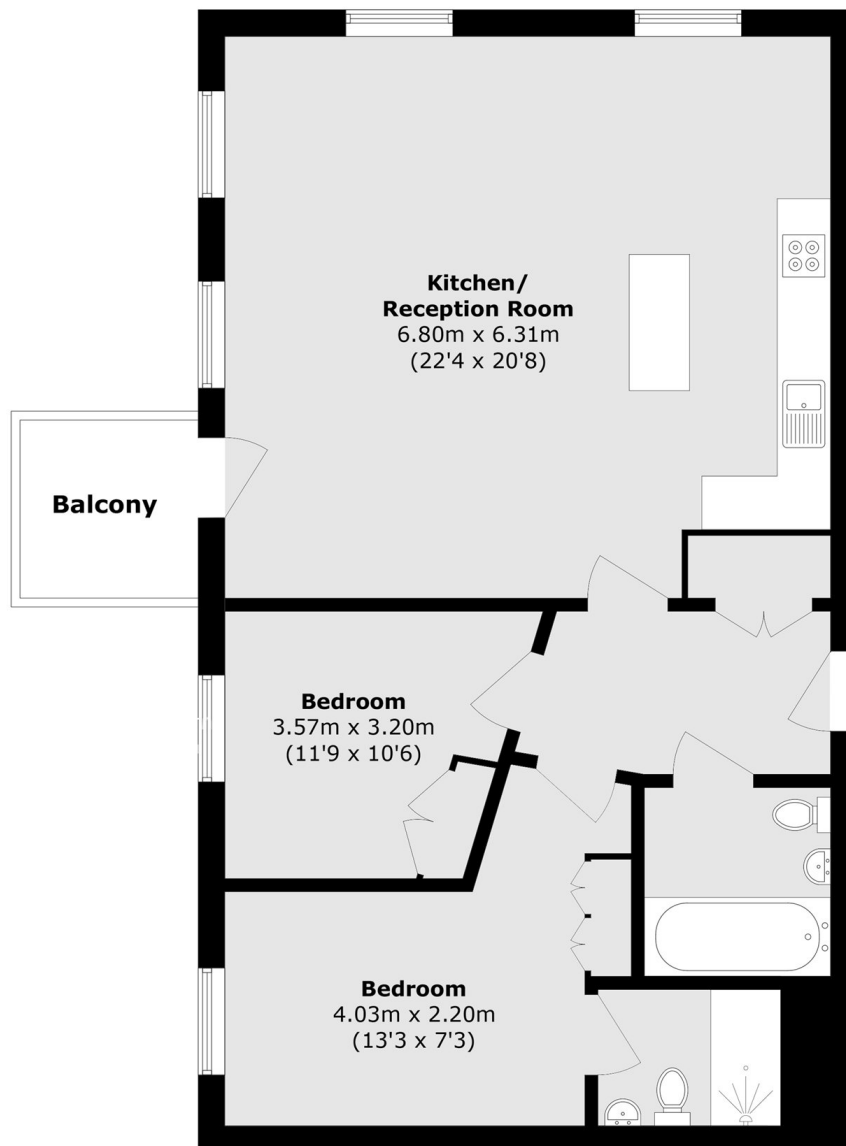

Total area (approx.): 83.2 sq. m (895.5 sq. ft)

Balcony area (approx.): 4.0 sq. m (43.0 sq. ft)

## Dexters

Islington  
76 Upper Street  
London  
N1 0NU  
Sales  
020 7483 6373

Energy Rating: . We aim to make our particulars both accurate and reliable. However they are not guaranteed; nor do they form part of an offer or contract. If you require clarification on any points then please contact us, especially if you're traveling some distance to view. Please note that appliances and heating systems have not been tested and therefore no warranties can be given as to their good working order.

 **RICS** | Regulated  
Estate Agent  
and Letting Agent

[dexters.co.uk](https://www.dexters.co.uk)