



De Beauvoir Crescent, N1

£485,000

A spacious one bedroom property set on the first floor of the much sought after Grand Canal Apartments. This flat benefits from open plan kitchen & living room, modern appliances, underfloor heating with hardwood floors and a large private terrace.

Located in De Beauvoir town with Haggerston Station 0.3 miles away, several bus routes on Kingsland Road & Southgate Road this property is within easy reach of the City. The green spaces of Shoreditch Park, De Beauvoir Square and Rosemary Gardens are also within easy reach.

Features

- Open Plan Living
- Private Terrace
- Modern
- Wooden Floors
- Under Floor Heating

De Beauvoir Crescent, London, N1

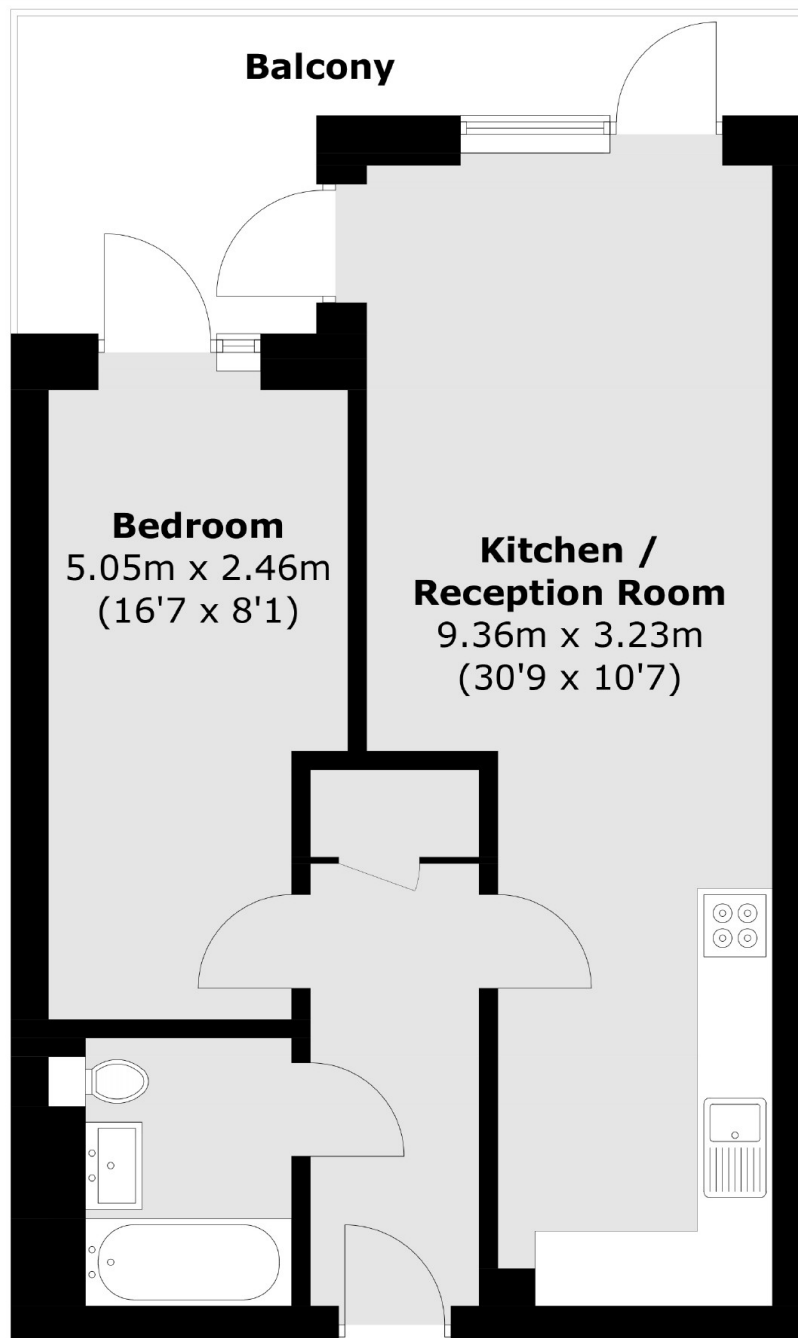

Total area (approx.): 49.5 sq. m (532.8 sq. ft)
Balcony: 9.2 sq. m (99 sq. ft)

Dexters

Islington
76 Upper Street
London
N1 0NU
Sales
020 7483 6373

Energy Rating: B. We aim to make our particulars both accurate and reliable. However they are not guaranteed; nor do they form part of an offer or contract. If you require clarification on any points then please contact us, especially if you're traveling some distance to view. Please note that appliances and heating systems have not been tested and therefore no warranties can be given as to their good working order.

 **RICS** | Regulated
Estate Agent
and Letting Agent

[dexters.co.uk](https://www.dexters.co.uk)