



## St. Peters Way, W5

### £480,000

A two double bedroom first floor purpose built flat in excellent condition throughout. Offered with no onward chain and set within a modern development the property also includes a garage.

St. Peters Way is located opposite the green space of Montpelier Park and the outstanding Montpelier primary school. For commuters you are approximately half a mile from Ealing Broadway with its wide range of shops, restaurants and transport options.

### Features

- Two Bedrooms
- First Floor
- Garage
- No Onward Chain
- Modern Condition
- Close To Outstanding School

St. Peters Way,  
London, W5

## First Floor

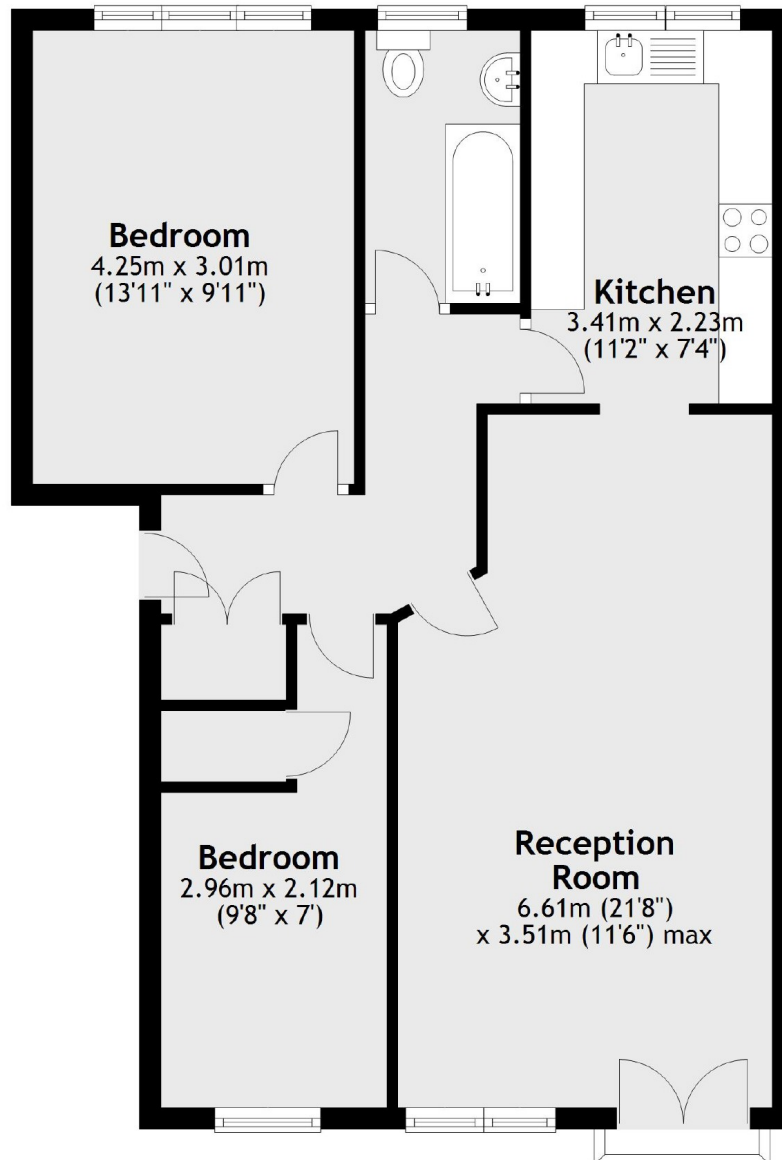

Total area: approx. 63.0 sq. metres (678.0 sq. feet)