



The Grove, W5

£365,000

A first floor one bedroom period conversion that has been newly modernised throughout. Offered with no onward chain, there are high ceilings throughout. There is an open plan kitchen/reception to the front, newly fitted bathroom, and a double bedroom to the rear.

The Grove is ideally located for the shops, amenities and transport links of Ealing Broadway, along with the Green space of Ealing Common at the other end of the road. There are multiple transport links such as the Elizabeth, Central and District Lines.

Features

- One Bedroom
- First Floor
- Newly Renovated
- Long Leasehold
- Centrally Located
- No Onward Chain

The Grove, London, W5

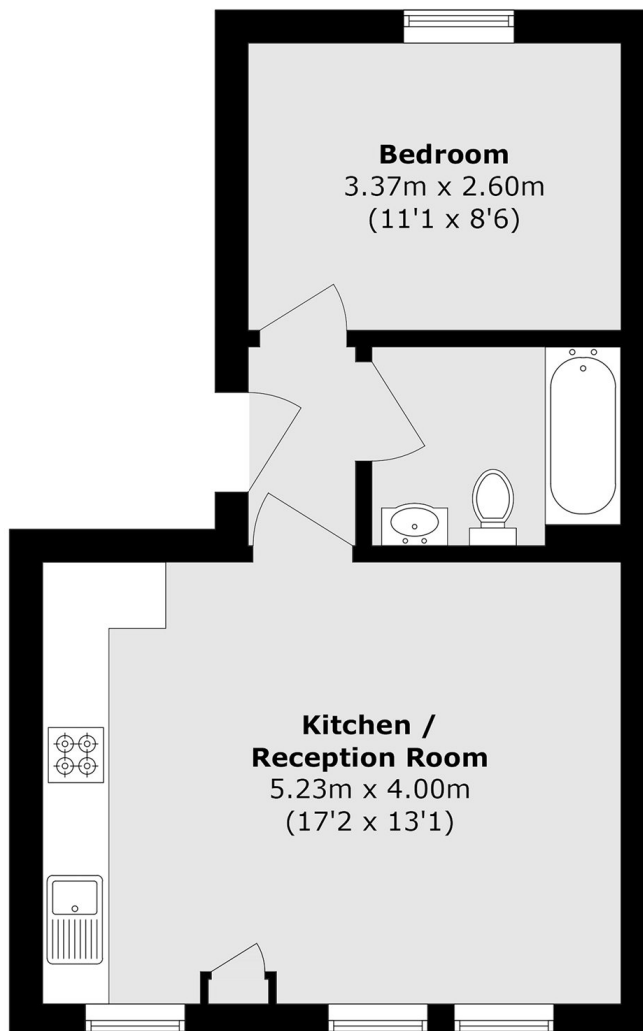

Total area (approx.): 36.8 sq. m (396.1 sq. ft)