



Drayton Gardens, W13

£1,050,000

A five bedroom mid terrace Edwardian property that has been ground floor extended and loft converted to create a wonderful family home. With high ceilings throughout, many period features have been retained whilst modern extensions give great living space.

Located in the popular Drayton's residential area with West Ealing station just a couple of minutes walk, linking Bond Street in fourteen minutes, thirteen to Heathrow Airport and approximately thirty to Canary Wharf. There are excellent local schools, state and private.

Features

- Five Bedrooms
- Two Bathrooms
- Period Features
- Ground Floor Extension
- Popular Residential Area
- Close To Station

Drayton Gardens, London, W13

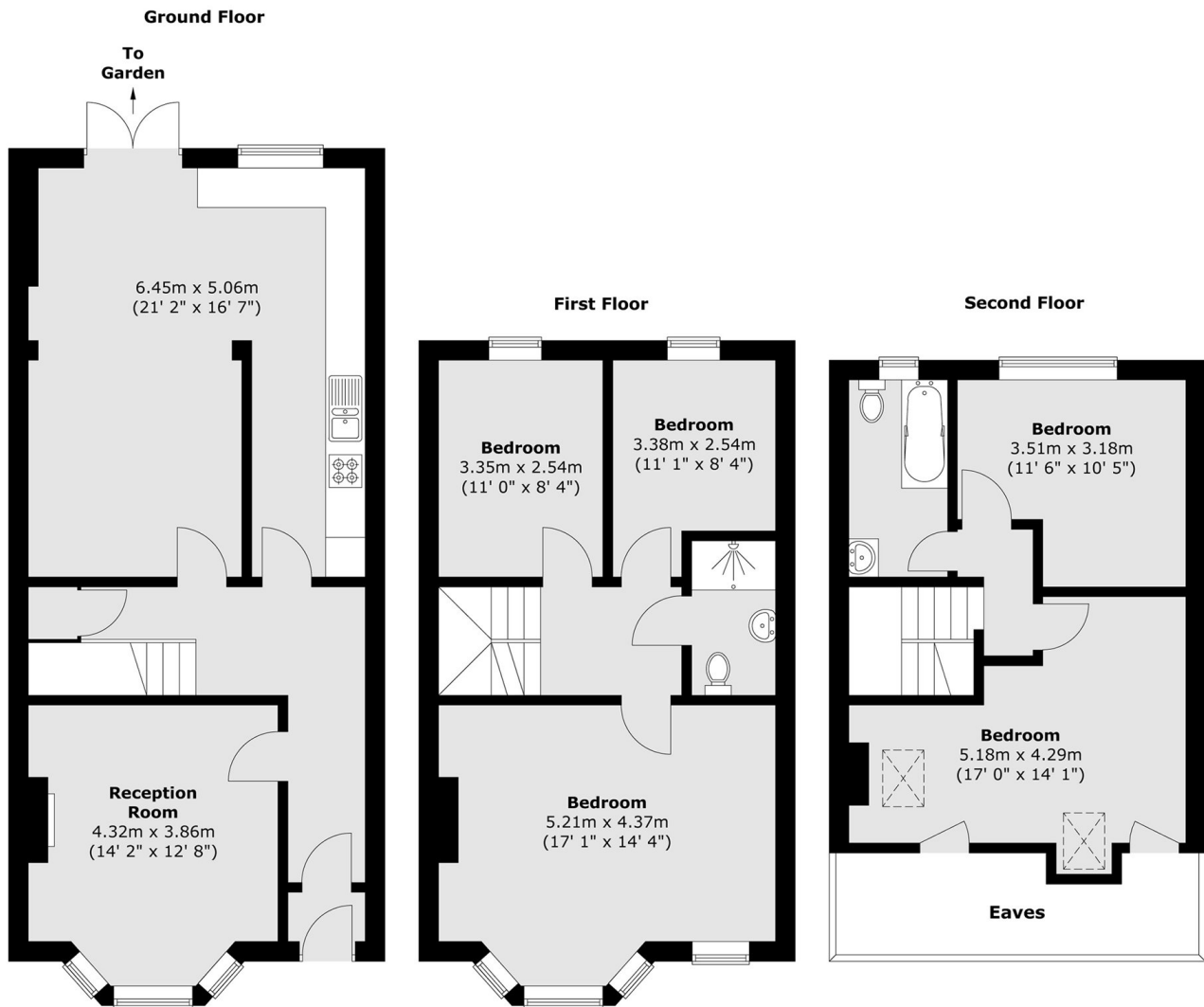

Total area (approx.) : 150 sq. m (1614 sq. ft)
(Excluding eaves)

Dexters

Ealing
2 New Ealing Broadway
London
W5 2NU
Sales
020 8810 0909

Energy Rating: C. We aim to make our particulars both accurate and reliable. However they are not guaranteed; nor do they form part of an offer or contract. If you require clarification on any points then please contact us, especially if you're traveling some distance to view. Please note that appliances and heating systems have not been tested and therefore no warranties can be given as to their good working order.

 **RICS** | Regulated
Estate Agent
and Letting Agent

[dexters.co.uk](https://www.dexters.co.uk)