



Colonnade Gardens, W3

£375,000

A modern one double bedroom apartment residing in a private gated community. The property has an open plan kitchen and living area with floor to ceiling windows and doors leading onto a south facing private balcony. Additionally there is a secure bike storage

Just over half a mile from Acton Central (Overground) and within a mile of Stamford Brook and Turnham Green tube stations (District line). Wendell Park and Acton Park are within walking distance as well as the amenities of Askew Road and Churchfield Road.

Features

- One Double Bedroom
- Private Balcony
- Over 580 Square Feet
- Lift Access
- Gated Development
- South Facing Balcony

Colonnade Gardens, London, W3

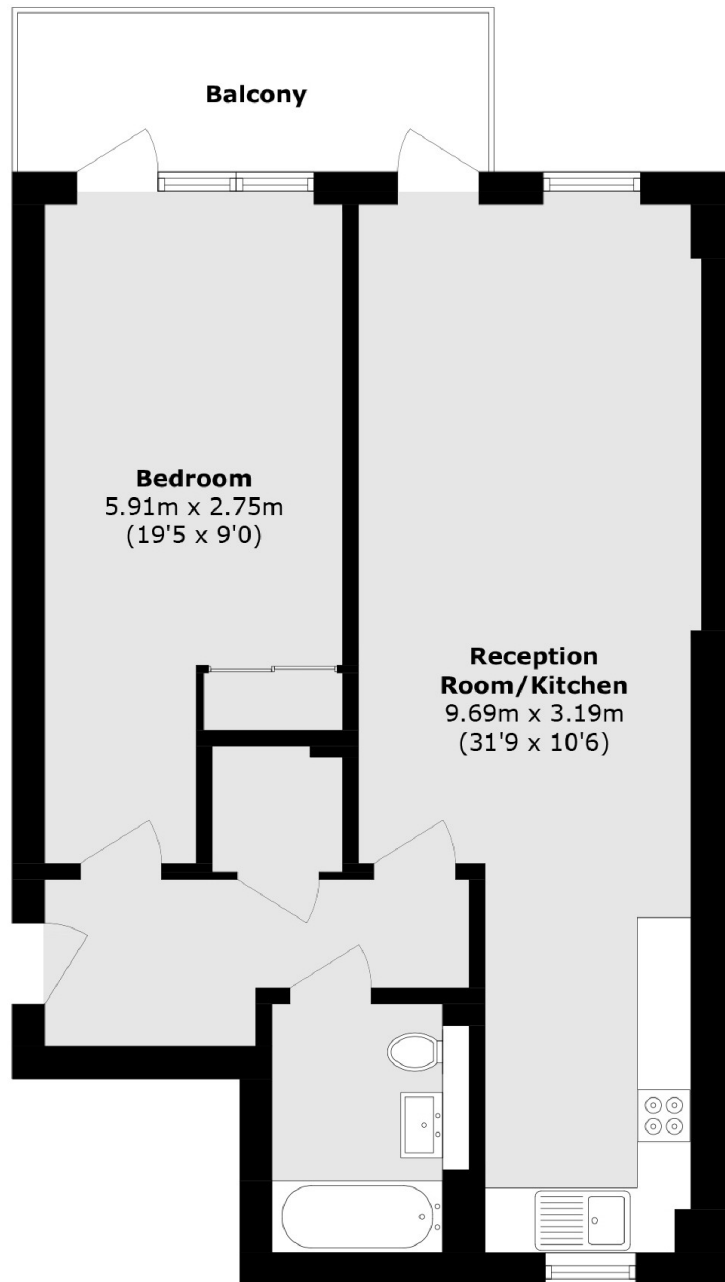

Total area (approx.): 54.8 sq. m (589.8 sq. ft)

Balcony area (approx.): 6.7 sq. m (72.1 sq. ft)

Dexters

Acton
171 High Street
London
W3 6LP
Sales
020 8896 2112

Energy Rating: B. We aim to make our particulars both accurate and reliable. However they are not guaranteed; nor do they form part of an offer or contract. If you require clarification on any points then please contact us, especially if you're traveling some distance to view. Please note that appliances and heating systems have not been tested and therefore no warranties can be given as to their good working order.

 **RICS** | Regulated
Estate Agent
and Letting Agent

[dexters.co.uk](https://www.dexters.co.uk)