



Westfields Road, W3

£550,000

This bungalow is situated less than 100 ft from North Acton Playing Fields where there are tennis courts and play areas.

West Acton tube station is less than half a mile away. North Acton and Acton Main Line stations are both less than a mile away.

Features

Semi-Detached
Three Bedroom
Large Garden
Potential to extend (STPP)
Close to transport links

Westfields Road,
London, W3

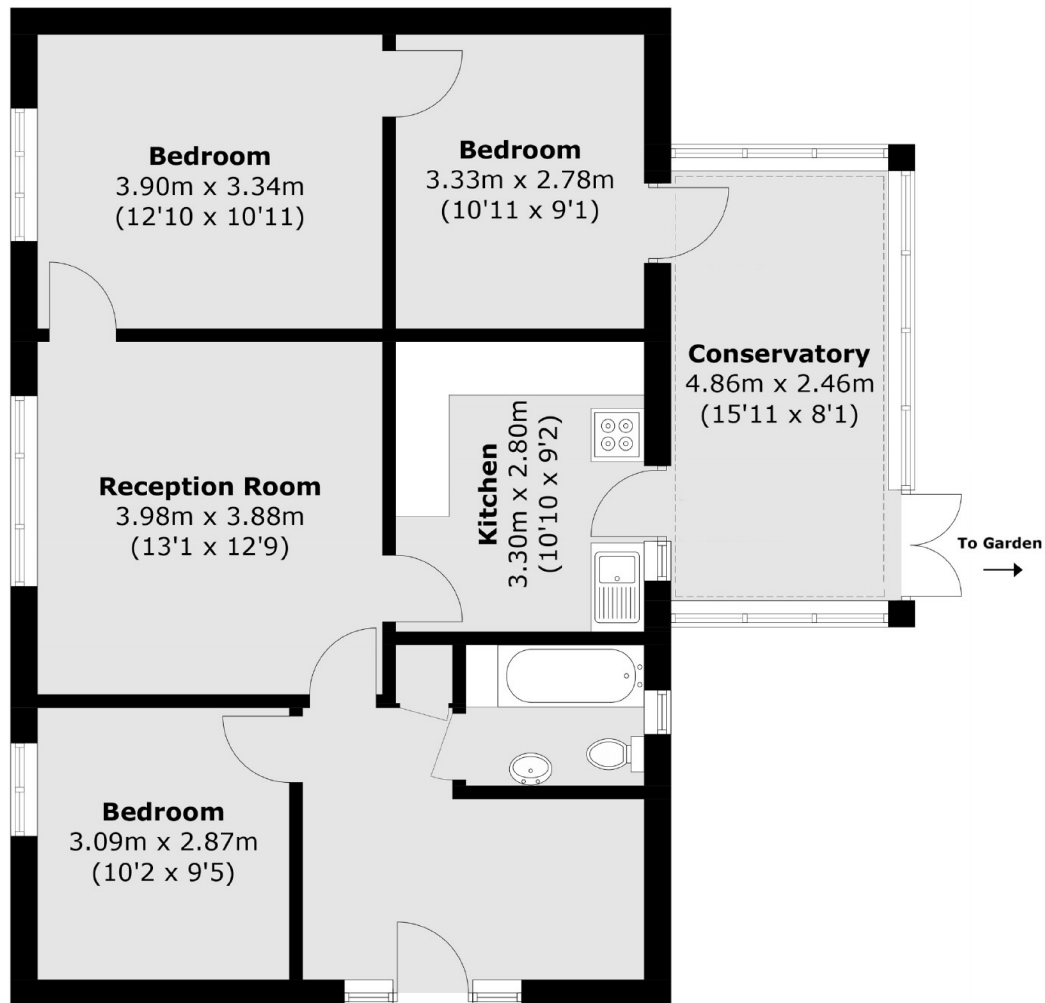

Total area (approx.): 86.6 sq. m (932.2 sq. ft)

Dexters

Acton
171 High Street
London
W3 6LP
Sales
020 8896 2112

Energy Rating: D. We aim to make our particulars both accurate and reliable. However they are not guaranteed; nor do they form part of an offer or contract. If you require clarification on any points then please contact us, especially if you're traveling some distance to view. Please note that appliances and heating systems have not been tested and therefore no warranties can be given as to their good working order.

RICS | Regulated
Estate Agent
and Letting Agent

[dexters.co.uk](https://www.dexters.co.uk)