



Abbeyfields Close, NW10

£325,000

A first floor flat spanning over 760 sq ft of living space, The property is filled with natural light, with two good size bedrooms, separate kitchen and reception room along with a private balcony overlooking the communal gardens. Additionally there is off street parking and being sold with no onwards chain.

Just over half a mile from Hanger Lane (Central line) and Park Royal (Piccadilly line) tube stations. Local bus routes include the 226 and there is access to major trunk roads including the A40 and A406 close by.

Features

Two Bedrooms
Separate Kitchen
First Floor
Private Balcony
Communal Garden
Allocated Parking Space

Abbeyfields Close, London, NW10

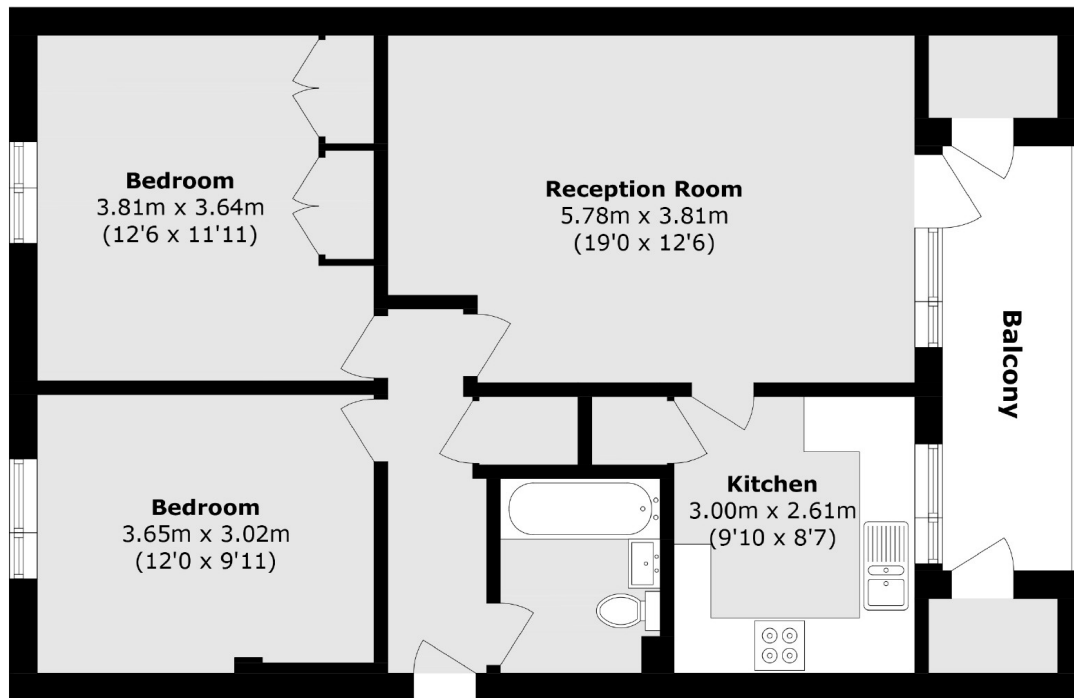

Total area (approx.): 65.8 sq. m (708.2 sq. ft)
External storage (approx.): 2.3 sq. m (24.7 sq. ft)
Balcony area (approx.): 6.4 sq. m (68.8 sq. ft)