



Victoria Road, W3

£250,000

A one bedroom apartment situated on the first floor of this popular development in North Acton, The entertaining space is open plan with floor to ceiling windows which allows an abundance of natural light and will be sold with no onwards chain.

North Acton station (Central line) is 2 minutes walk away and Acton Main Line station (Elizabeth line) is half a mile away. Westfield Shopping Centre, café's and restaurant are within close proximity.

Features

- One Double Bedroom
- Open Plan
- Lift Access
- Long Lease
- Close to Tube Station
- No Onward Chain

Victoria Road,
London, W3

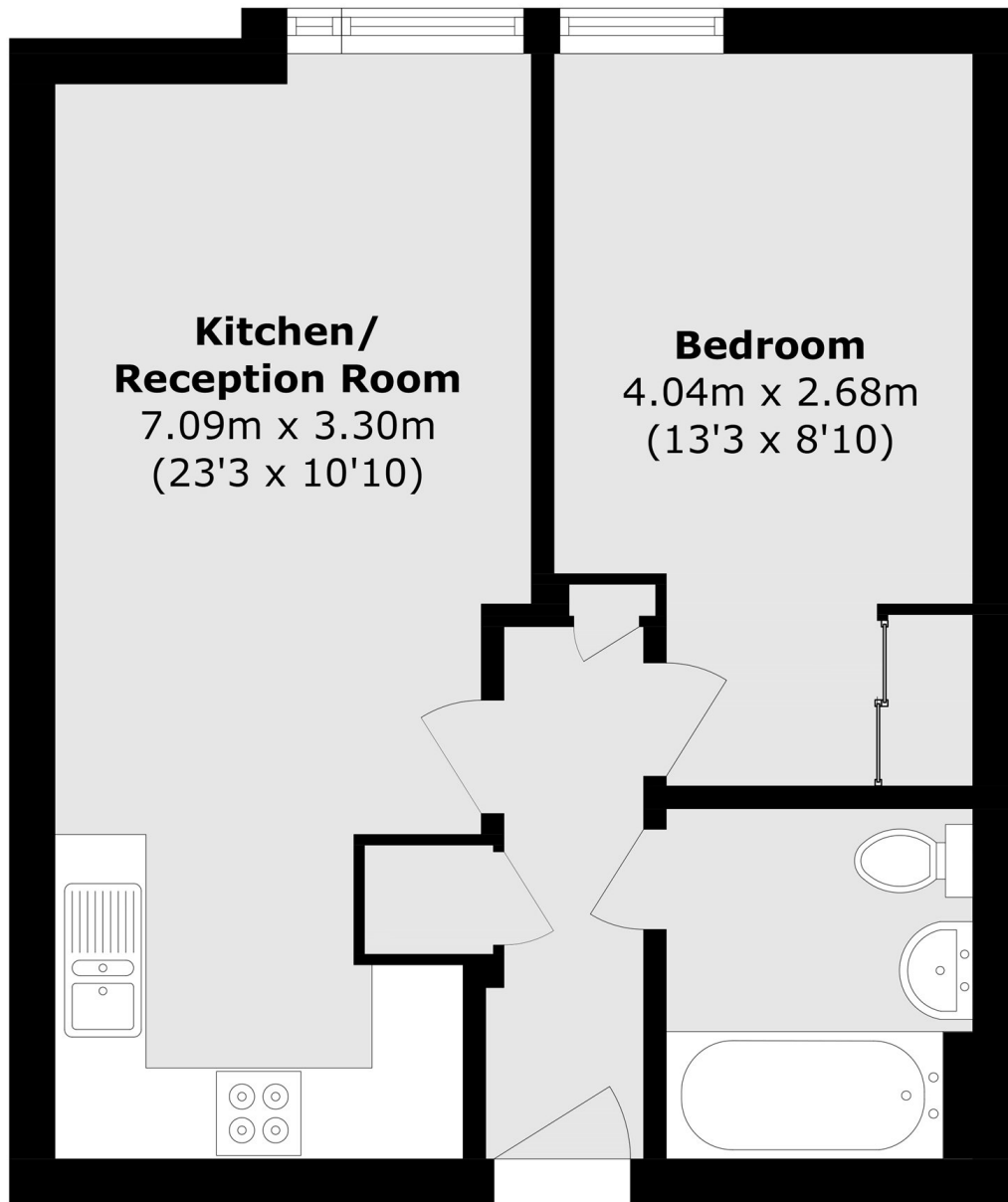

Total area (approx.): 43.4 sq. m (467.1 sq. ft)