



Julian Avenue, W3

£830 Per week

This beautiful three bedroom house would be suitable for a family who are looking for space and comfort. The property has been recently renovated and comes with a private garden, family bathroom and separate WC.

Julian Avenue is situated within the amenities of Acton and Churchfield Road. The property has many transport links including Acton Central, Acton Mainline and North Acton stations within walking distance, it is also close to the A40 motorway into and out of London.

Features

- Family Home
- Three Bedrooms
- Modern Interior
- Private Garden
- Recently Renovated
- Spacious Reception Room

Julian Avenue, London, W3

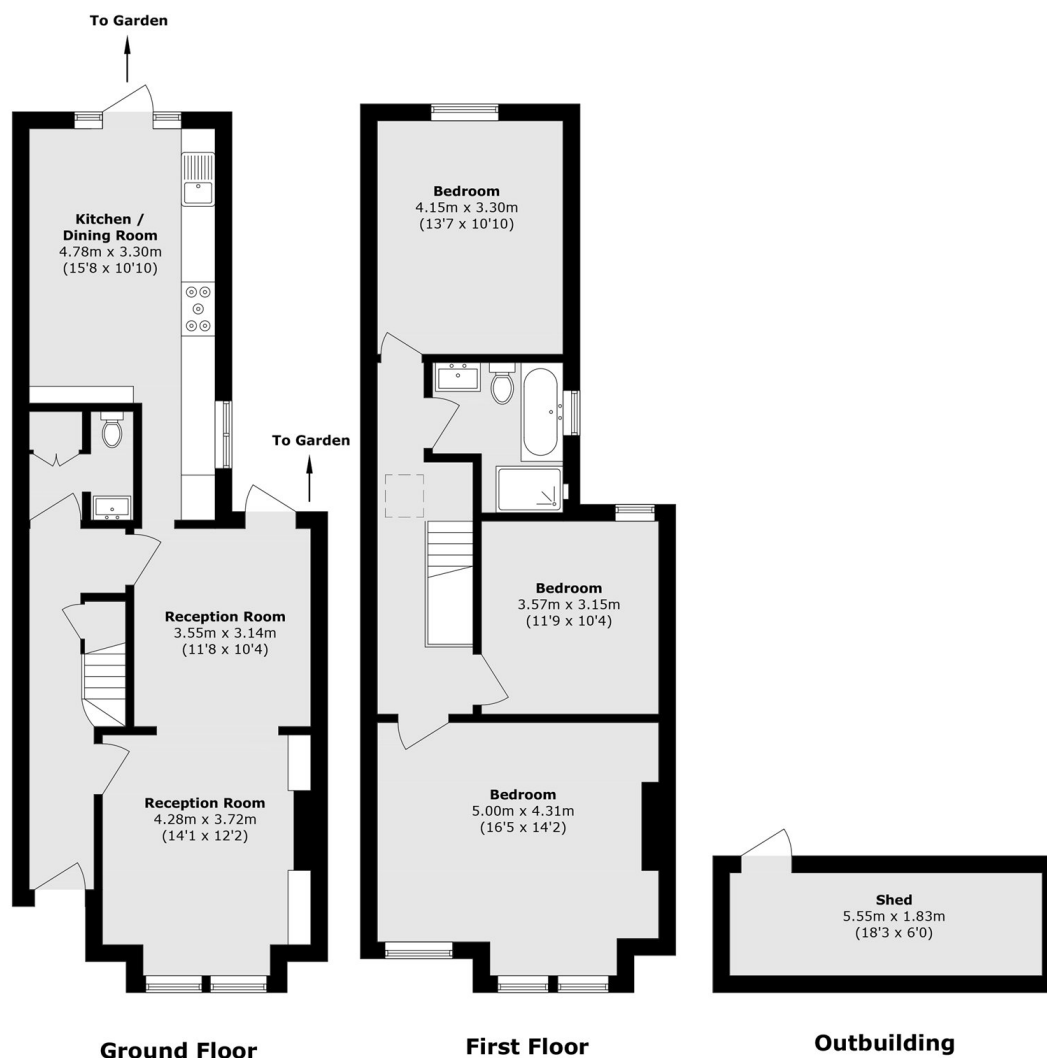

Total area (approx.): 122.6 sq. m (1319.6 sq. ft)
Outbuilding area (approx.): 10.1 sq. m (108.7 sq. ft)