



Chiswick Village, W4

£450,000

Offered to the market with no onward chain, this beautifully presented two double bedroom fourth-floor apartment is ideally positioned within one of the area's most highly sought-after developments. Enjoying an elevated outlook, the property combines charm, space, and convenience, making it an exceptional opportunity for both homeowners and investors alike.

Chiswick Village is within half a mile of Gunnersbury Station (District & Overground), Kew Bridge Station (GWR) and the M4/A4 providing excellent access into and out of London. Highly regarded schools such as Strand on the Green, local amenities, restaurants and the River Thames are also close by.

Features

- Fourth Floor
- Two Double Bedrooms
- Lift Access
- Share Of Freehold
- Private Balcony
- No Onward Chain

Chiswick Village, London, W4

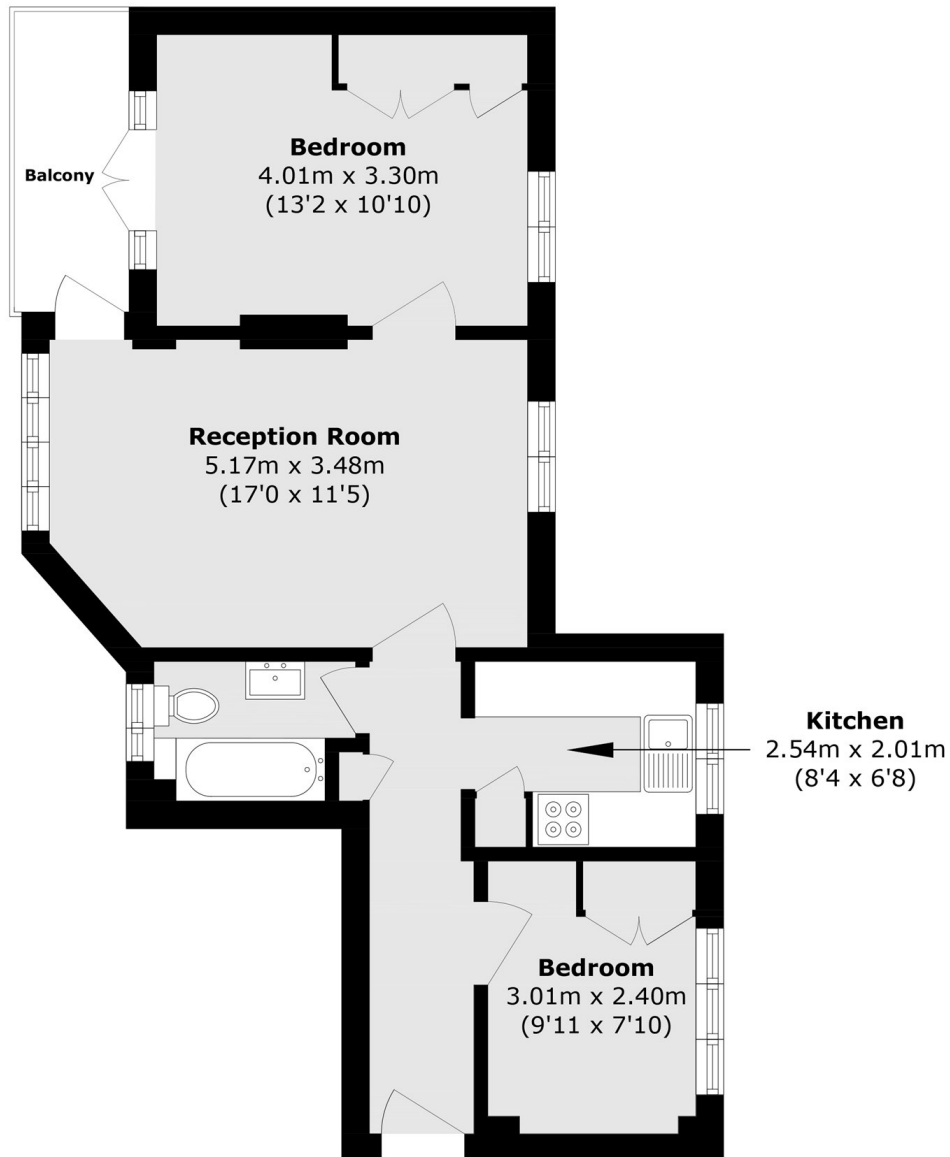

Total area (approx.): 52.0 sq. m (559.7 sq. ft)

Balcony area (approx.): 3.9 sq. m (41.9 sq. ft)