



## Chiswick Road, W4

£357 Per week

A one bedroom apartment located in this popular building consisting of an open plan reception with a fitted kitchen, a double bedroom and a modern shower room.

Chiswick Road runs parallel to Chiswick High Road and is ideally located for all of its amenities as well as Chiswick Park station and Chiswick Business Park.

### Features

One Bedroom  
Second Floor  
Open Plan  
Central Location  
Transport Links  
Purpose Built

Chiswick Road,  
London, W4

## Second Floor

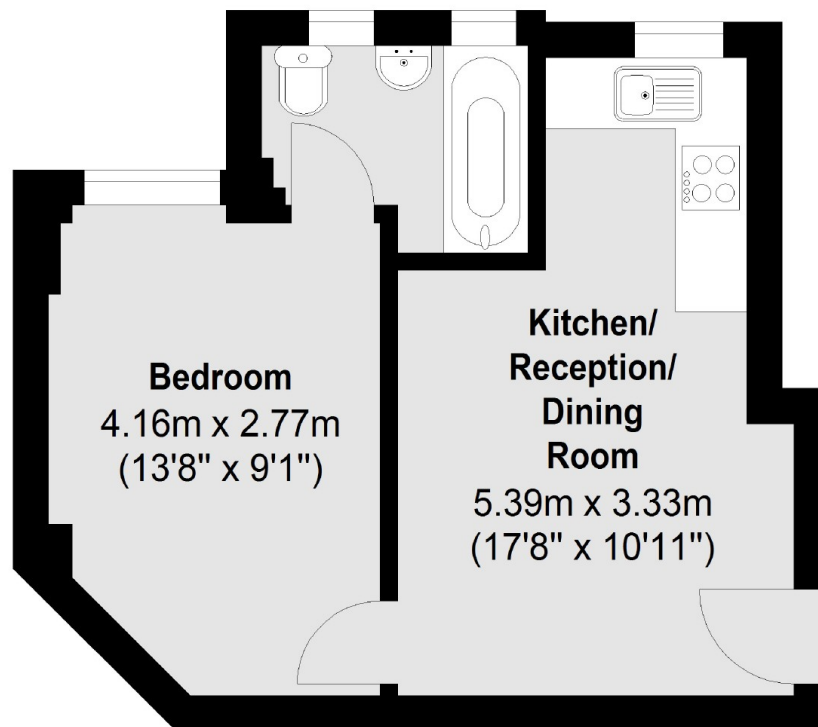

Internal Area (approx.): 29.8 sq. m (320.8 sq. ft)