



Roehampton Vale, SW15

£750,000

Dexters



Roehampton Vale, SW15

A beautiful, 1730 sq ft, semi detached house, offered to the market chain free. This three double bedroom, period family home, with wrap around garden, offers a fantastic opportunity to renovate and add value.

This property is set back from the A3 behind a high wall and is located by Richmond Gate & Putney Heath allowing easy access into Putney, Roehampton & also Wimbledon.

Features

- Offers In Excess of
- Three Bedrooms
- Two Bathrooms
- Chain Free
- Wrap around Garden
- Semi Detached







Roehampton Vale, London, SW15

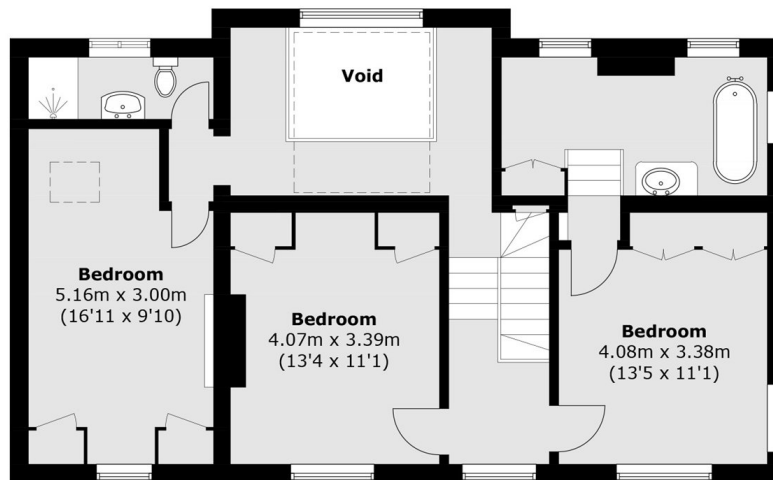

First Floor

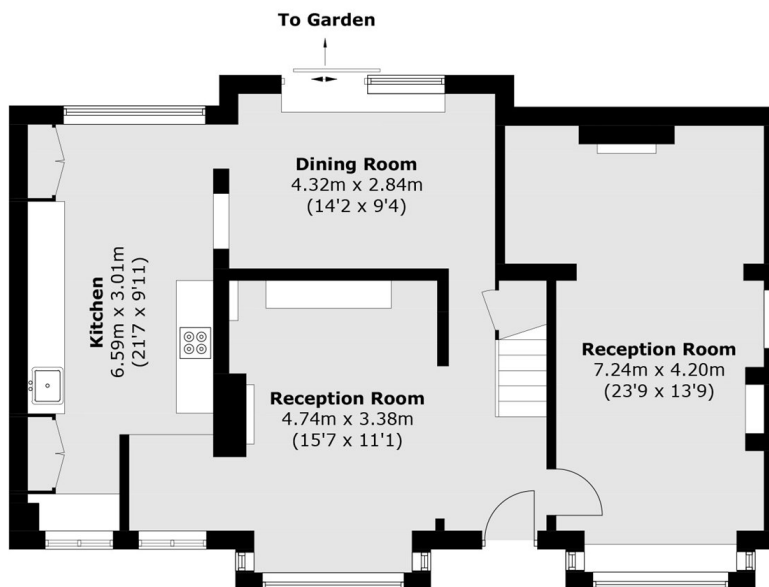

Ground Floor

Total area (approx.): 160.8 sq. m (1,730.8 sq. ft)
(Excluding Void)