



Cotman Close, SW15

£2,700 Per calendar month

Dexters



Cotman Close, SW15

A spacious and contemporary two double bedroom apartment, set within a private gated development on the first floor. Recently refurbished to a high standard, featuring brand new appliances throughout. Further benefits include communal gardens and first come, first served parking.

Cotman Close is located on Westleigh Avenue, just off Putney Hill, within easy walking distance to Putney High Street with its array of excellent shopping facilities, bars and restaurants and the transport links of Putney Mainline Station.

Features

- First Floor Flat
- Two Double Bedroom
- Integrated Kitchen
- New Tiled Bathroom Suite
- Communal Garden
- Access To Parking



Cotman Close,
London, SW15

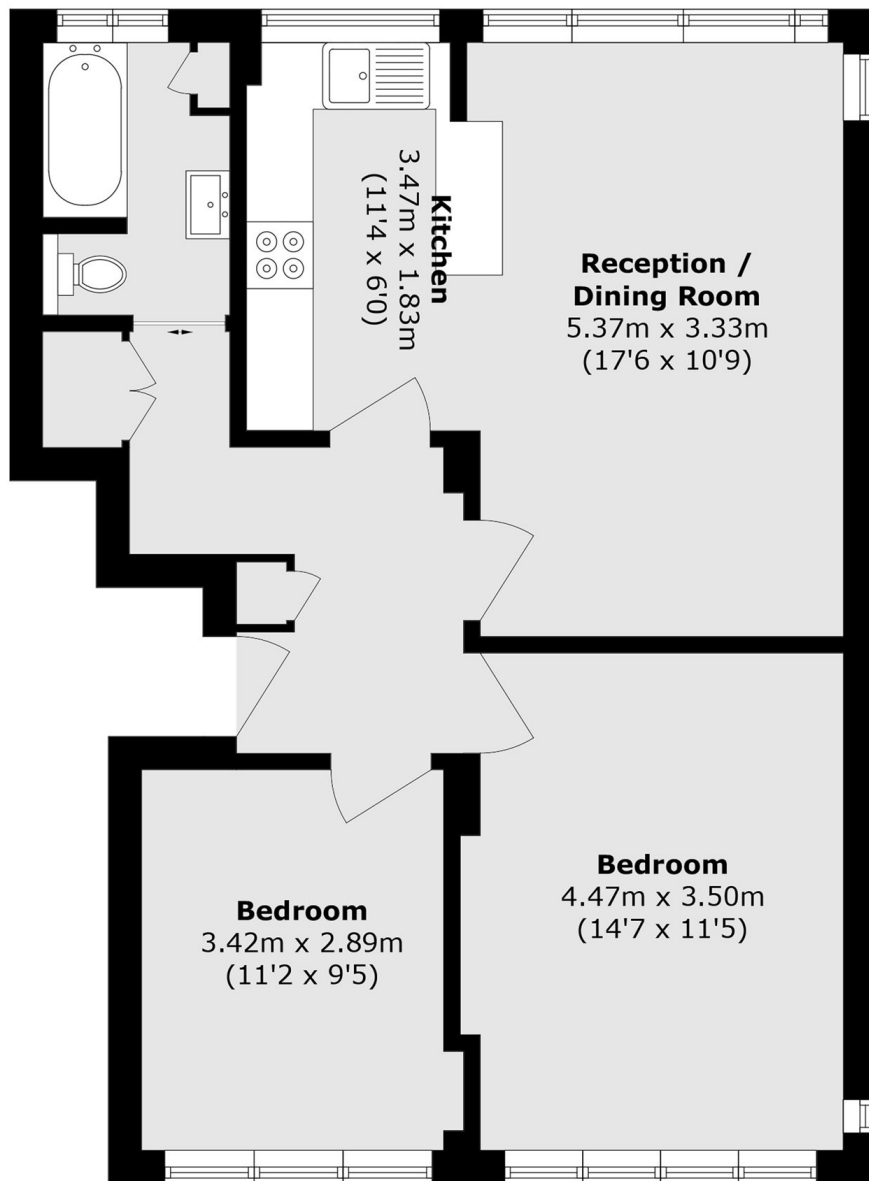

Total area (approx.): 64.4 sq. m (693.2 sq. ft)