



## Upper Richmond Road, SW15

### £425,000

A superb two double bedroom, 618 Sq. Ft, ground floor flat, with residents off-street parking, located in this sought-after purpose built block.

The apartment comprises of a spacious living room with solid wood parquet flooring throughout providing for ample reception and dining space. The master bedroom offers plenty of space and has copious amounts of built-in storage space. There is also a second good-sized double bedroom and a modern bathroom. The property benefits from Share of Freehold & long lease.

Belvedere Court is located off the Upper Richmond Road in West Putney, with both Putney and Barnes train stations within easy reach, excellent bus routes on the door step and Close proximity to Putney Leisure Centre.

### Features

- Two Bedrooms
- Chain Free
- Residents Off Street Parking
- Share of Freehold
- 618 Sq.Ft
- 13 Min Walk to Putney Station

# Upper Richmond Road, London, SW15

Ground Floor

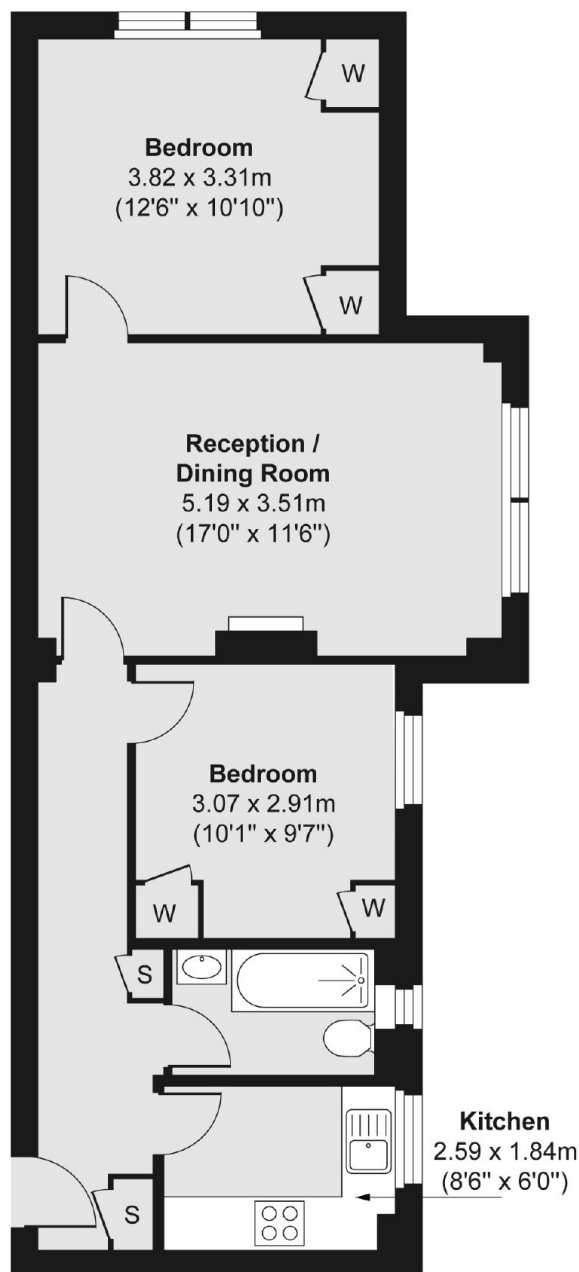

Total area (approx.) 57.42 sq. m (618 sq. ft)