

Clarence Lane, SW15

£1,950 Per calendar month

A beautifully presented two bedroom property set over two floors with views over Richmond Park. This property offers a large fully fitted kitchen with dedicated dining area that flows through to the spacious living room.

Putney and Roehampton are both within reach as are other desirable areas such as Barnes and Wimbledon. Queen Marys Hospital is just up the road as is Roehampton University and Ibstock Place School.

Features

- Two Double Bedrooms
- Split Level
- Furnished
- Great Size
- Modern
- Separate Kitchen

Clarence Lane, London, SW15

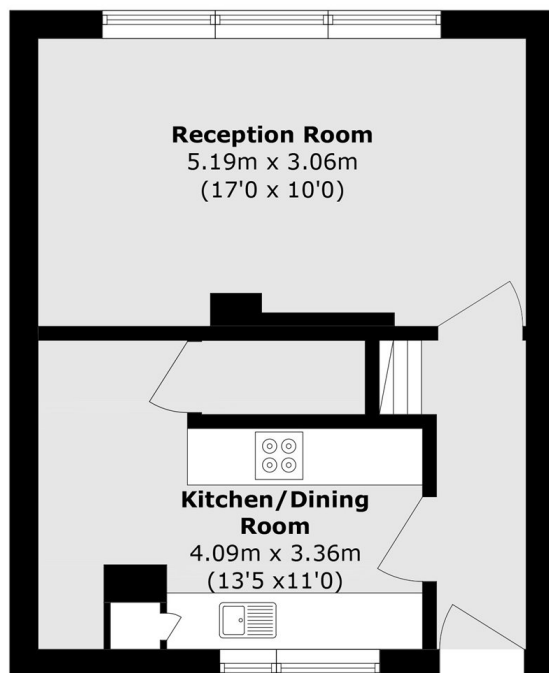

First Floor

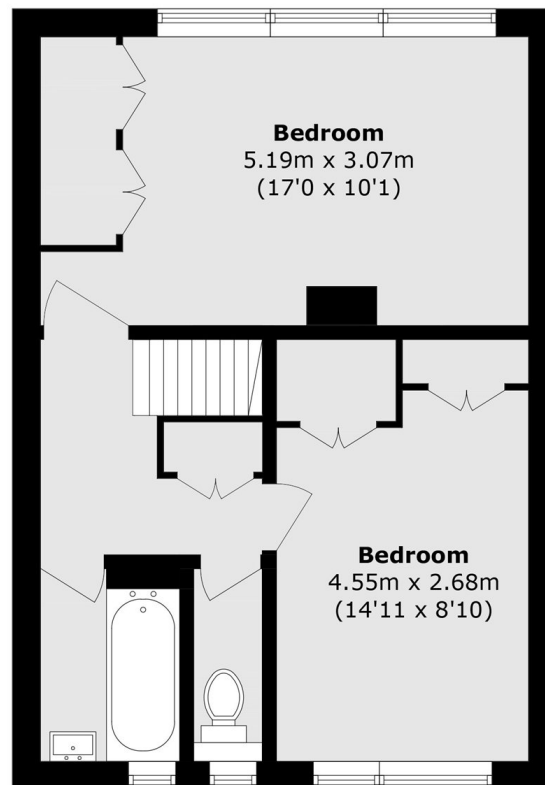

Second Floor

Total area (approx.): 73.7 sq. m (793.3 sq. ft)