

## Greyhound Road, W14

£2,250 Per calendar month

This one bedroom property situated in a modern development with lift a service. The property is situated on the third floor with a superb living area and kitchen, giving you lots of space to entertain, a double bedroom and a bathroom.

This property is situated in a popular residential location close to Barons Court and West Kensington station and on the doorstep to the famous Queens Tennis Club. You have a fantastic choice of local pubs, restaurants and independent shops and the River Thames close by.

### Features

- One Bedroom
- Wood Flooring
- Lift Access
- Fitted Storage
- Modern Development
- Furnished

Greyhound Road,  
London, W14

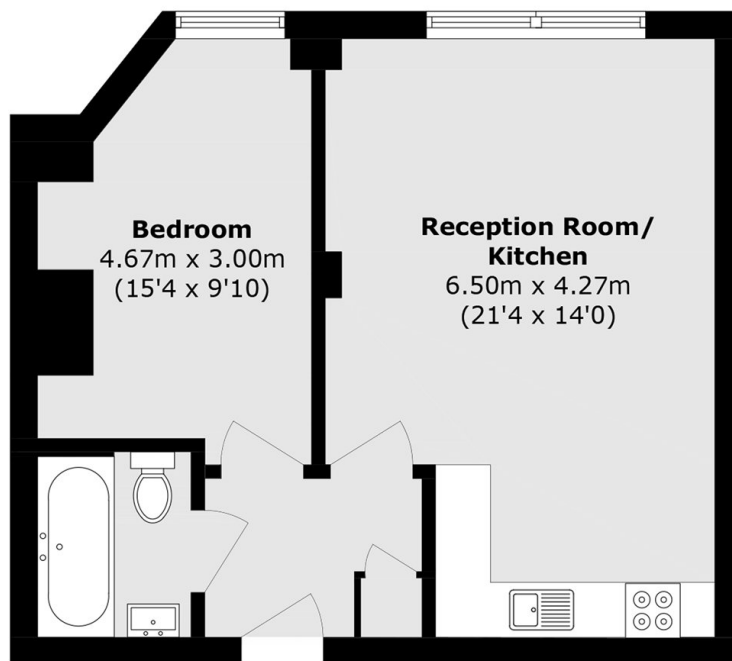

Total area (approx.): 47.5 sq. m (511.3 sq. ft)