



Queen's Club Gardens, W14

£2,750 Per calendar month

This two bedroom property on the raised ground floor of a red brick mansions block located in one of the most desirable developments in South West London offers two fantastic double bedrooms, a recently refurbished separate kitchen and a great living room.

Queen's Club Gardens is located adjacent to the Queen's Club tennis, close to shops, cafes, bars and restaurants and is only a short walk to Barons Court and West Kensington underground stations.

Features

- Two Bedrooms
- One Bathroom
- Red Brick Mansion Block
- Separate Kitchen
- Communal Gardens
- Communal Tennis Courts

Queen's Club Gardens, London, W14

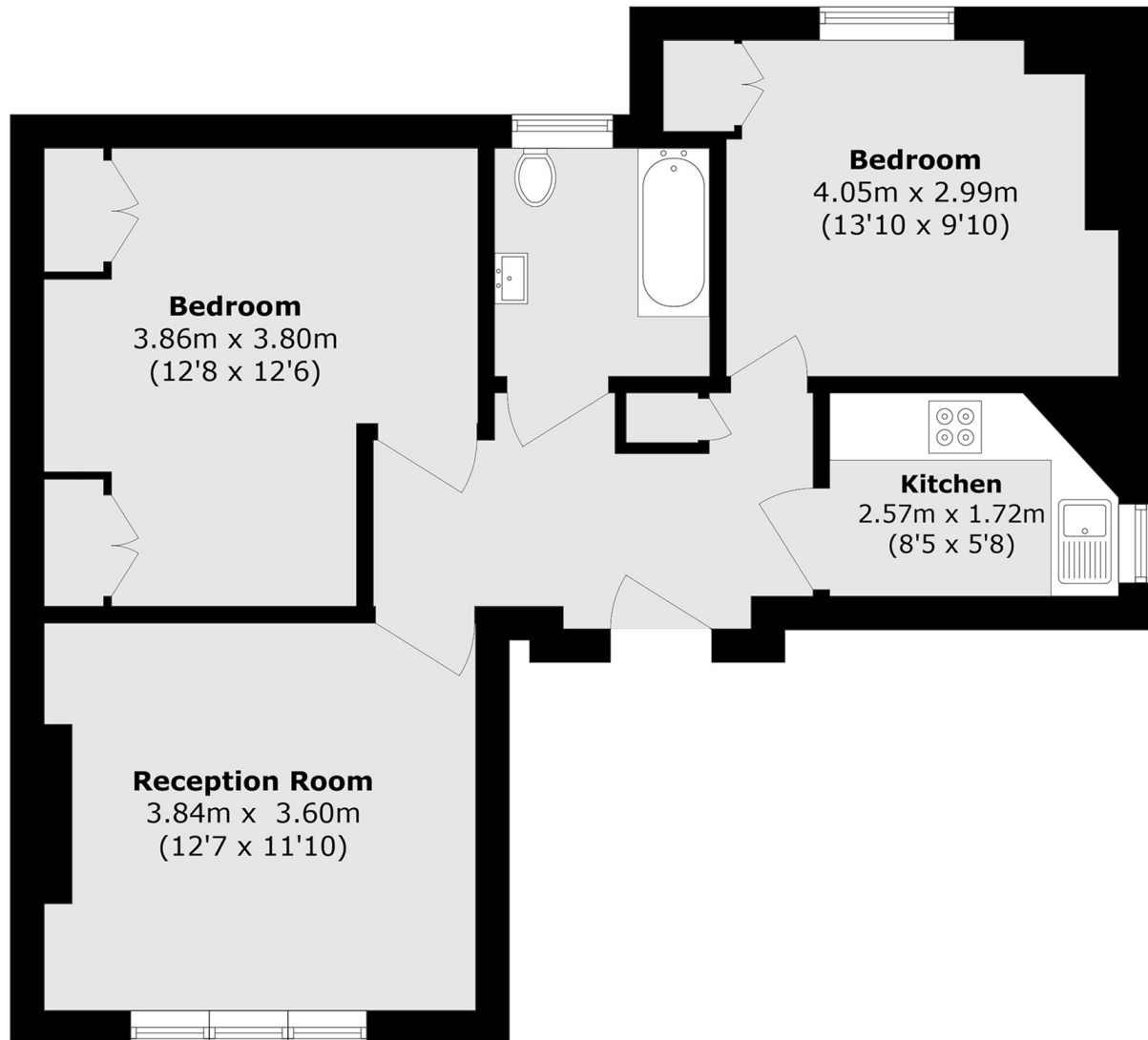

Total area (approx.): 56.8 sq. m (611.3 sq. ft)