



## Bagleys Lane, SW6

### £450,000

A spacious and well-finished two-bedroom, second-floor apartment set within a secure gated development, benefiting from underground parking, concierge services, a lift and well-maintained communal gardens. The open-plan kitchen and living area features fully integrated appliances and provides direct access to a private roof terrace.

Bagleys Lane is a quiet residential street conveniently situated near the amenities of Imperial Wharf and the scenic Thames Path along the river. Local transport links are easily accessible with both Fulham Broadway, Wandsworth Bridge Road and Parsons Green within a short walk.

### Features

- Two Bedrooms
- Private Roof Terrace
- Modern Interiors
- Open Plan Kitchen Living
- Concierge and Lift
- Designated Secure Gated Parking

# Bagleys Lane, London, SW6

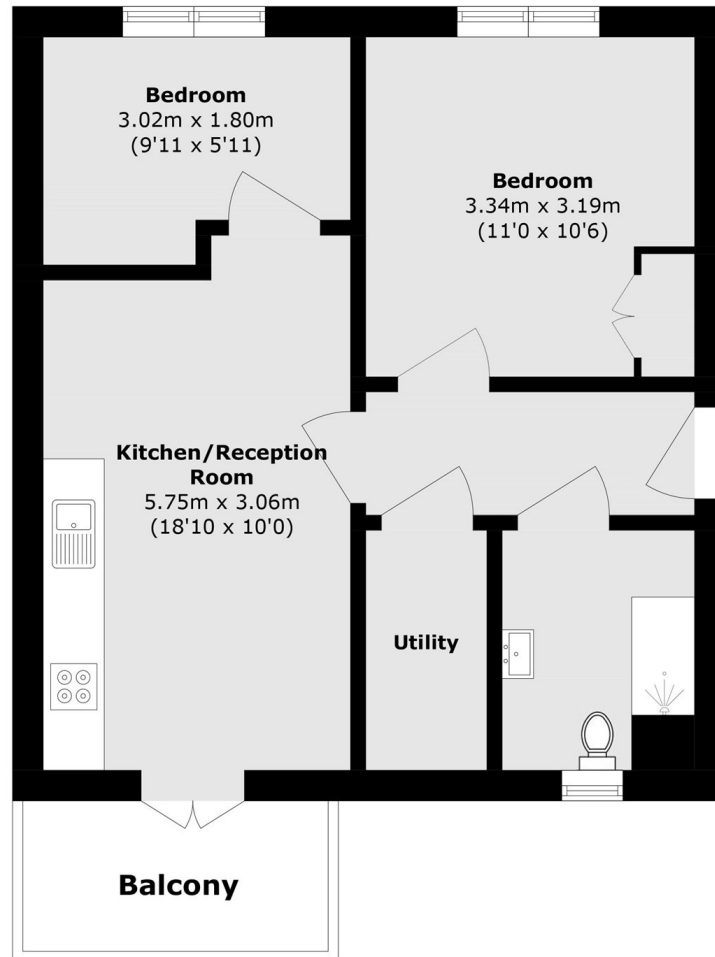

## Second Floor

Total area (approx.): 46.1 sq. m (496.2 sq. ft)

Balcony area (approx.): 4.4 sq. m (47.3 sq. ft)