



## Gipsy Road, SE27

£625,000

Offered with no onward chain and with plenty of potential is this three bedroom family home. With separate reception and open-plan kitchen/diner this home has plenty of space to enjoy. Double doors lead onto the large garden which has a split level configuration as well as side access. Upstairs there are three bedrooms and a modern bathroom with four piece suite. This property also comes with off street parking and potential to extend.

Gipsy Road is centrally located equidistant between Gipsy Hill and West Norwood stations. Norwood Park open space is nearby, and there is local shopping at the east end of Gipsy Road and in Norwood High Street.

### Features

- Three Bedrooms
- Off-Street Parking
- Large Garden
- Chain Free
- Potential to extend
- Side Access

# Gipsy Road, London, SE27

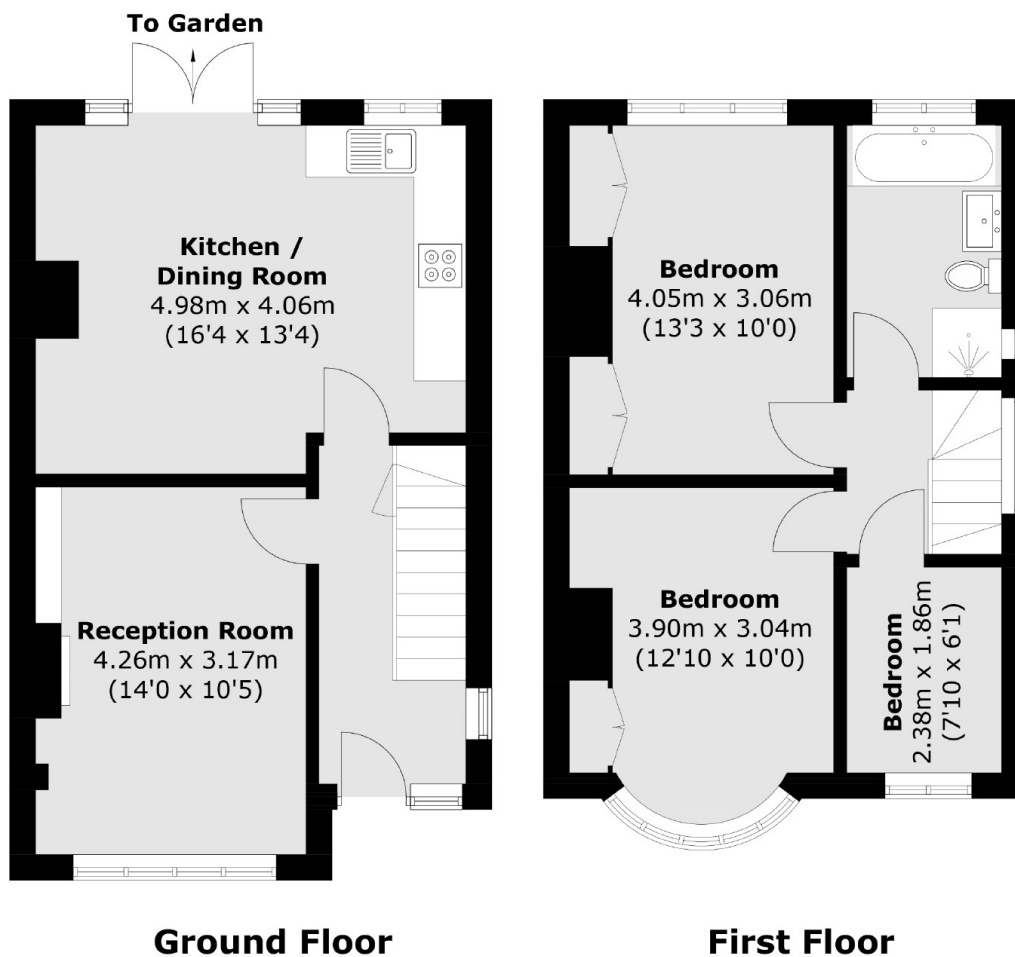

Total area (approx.): 79.2 sq. m (852.5 sq. ft)

**Dexters**

Streatham  
105 Streatham Hill  
London  
SW2 4UG  
Sales  
020 8674 7400

Energy Rating: D. We aim to make our particulars both accurate and reliable. However they are not guaranteed; nor do they form part of an offer or contract. If you require clarification on any points then please contact us, especially if you're traveling some distance to view. Please note that appliances and heating systems have not been tested and therefore no warranties can be given as to their good working order.

 **RICS** | Regulated  
Estate Agent  
and Letting Agent

[dexters.co.uk](https://www.dexters.co.uk)